

7TH ANNUAL
EUROPEAN FUND
FINANCE SYMPOSIUM



FUND
FINANCE
association

AGENDA AT A GLANCE

Time	Session	
8:30 – 9:30 AM	Registration Open	
	Track A – Whittle & Fleming	Track B – Churchill
9:30 – 9:35 AM	Opening Remarks	
9:35 – 10:00 AM	The Fog is Getting Thicker: What is the Impact for Investors?	
10:00 – 10:15 AM	Networking Break	
10:15 – 11:00 AM	Evolution of Fund Finance	Legal Update: Implications of Defaulting Lenders
11:00 – 11:15 AM	Networking Break	
11:15 – 12:00 PM	NAV 2.0 – Concentrated Collateral and Equity Underlying	NAV 1.0 – Diversified Collateral and Debt Underlying
12:00 – 1:30 PM	Lunch Break	
1:30 – 2:15 PM	Non-Bank Lenders – Current Status and What is Needed for More Growth	Structuring and Managing Risk in 2023
2:15 – 2:30 PM	Networking Break	
2:30 – 3:15 PM	Fund Finance ESG Trends and Recent Developments	Rating, Capital Relief Structures, and Risk Transfer
3:15 – 3:30 PM	Networking Break	
3:30 – 4:15 PM	Innovation and New Structures	Key Trends in NAV and Subline Financings
4:15 – 4:30 PM	Networking Break	
4:30 – 5:00 PM	Preqin Update	
5:00 – 5:05 PM	Closing Remarks	

AGENDA

JUNE 19, 2023

Opening Remarks

Fleming & Whittle

9:30 - 9:35 AM

Emma Russell, Partner, Haynes Boone

The Fog is Getting Thicker: What is the Impact for Investors?

Fleming & Whittle

9:35 - 10:00 AM

Mabrouk Chetouane, Head of Global Market Strategy, Natixis

Evolution of Fund Finance

Fleming & Whittle

10:15 - 11:00 AM

MODERATOR:

Alex Griffiths, Executive Director, Head of Structuring, MUFG Investor Services

PANELISTS:

Nicola Germano, Managing Director - Financial Sponsor Group, Intesa Sanpaolo IMI Corporate & Investment Banking Division

Sabih Hussain, Global Head of Fund Finance, Barings

Phillippe Max, Partner, Dentons

Andy Roberts, Senior Director, RBS International

Olivier Vermeulen, Paris Office Chair, Head Finance Departement, Paul Hastings

Raghav Wadhawan, Executive Director, Standard Chartered Bank

Legal Update: Implications of Defaulting Lenders

Churchill

10:15 - 11:00 AM

- A review of the customary documentary position regarding Defaulting Lenders
- Analysis of Defaulting Lender consideration in practice
- Considerations for both borrowers and lenders of Defaulting Lender
- A discussion of any changes to Defaulting Lender provisions as a result of recent market events

MODERATOR:

Kate Sinclair, Partner, Simpson Thacher & Bartlett LLP

PANELISTS:

Matt Lilley, Counsel, Mayer Brown LLP

Paul Worsnop, Counsel, Appleby

Vassiliyan Zanev, Partner, Loyens & Loeff

Nav 2.0 - Concentrated Collateral and Equity Underlying

Fleming & Whittle

11:15 - 12:00 PM

MODERATOR:

Emma Russell, Partner, Haynes Boone

PANELISTS:

Kathryn Cecil, Partner, Fried Frank

Gianluca Lorenzon, Head of Fund Finance Advisory, Validus

Steven Mansy, Head of Fund Finance Origination EMEA, Macquarie Group

Michael Schad, Partner, Collier Capital

Marco Unti, Managing Director, Deutsche Bank

NAV 1.0 - Diversified Collateral and Debt Underlying

Churchill

11:15 - 12:00 PM

MODERATOR:

Leon Stephenson, Partner, Reed Smith

PANELISTS:

Navdeep Benning, Partner, Ashurst LLP

Aldo Di Rienzo, Chief Financial Officer, Rothschild & Co

Matt Glen, Director, Sponsors Strategic Origination & Partnerships, Lloyds Bank

Jamie Mehmood, Head of Fund Finance Advisory, Deloitte

John Sayers, Partner, Simmons & Simmons LLP

Non-Bank Lenders – Current Status and What is Needed for More Growth

Fleming & Whittle

1:30 - 2:15 PM

MODERATOR:

Richard Fletcher, Partner, Macfarlanes

PANELISTS:

Andrew Husdan, Partner, Clifford Chance LLP

Shelley Morrison, Head of Fund Finance, abrnd

Stephen Quinn, Senior Managing Director, 17 Capital

Slade Spalding, Partner, NLC Capital Partners LLP

Victoria Stewart, Global Head Fund Financing, Partners Group

Structuring and Managing Risk in 2023

Churchill

1:30 - 2:15 PM

MODERATOR:

Jad Nader, Partner, Ogier

PANELISTS:

Ahlem Ben Gueblia, Head of Financial Sponsors Europe, ANZ

Richard Braham, Executive Director Intelligent Finance Global Client Solutions IB&M UK, Commonwealth Bank of Australia (CBA)

Giovanni Di Stefano, Managing Director

Roxana Mirica, Partner, Head of Capital Markets

Fund Finance ESG Trends and Recent Developments

Fleming & Whittle

2:30 - 3:15 PM

MODERATOR:

David Lazar, Senior Director - Portfolio Manager and Head of Product Delivery Architecture, Allvue Systems

PANELISTS:

Sukhvir Basran, Partner, Financial Services and ESG, Cadwalader, Wickersham & Taft

Greg Brown, Partner, Allen & Overy LLP

Faatwima Diljore, Head of ESG and Fund Financing, AlbaCore Capital Group

Russell Evans, Head of Funds Client Coverage, Europe | Fund Sponsors, Strategic Investors and Alternatives Assets, National Australia Bank Limited

Simon Witney, Senior Consultant, Financial Services & Markets, Travers Smith LLP

Ratings, Capital Relief Structures, and Risk Transfer

Churchill

2:30 - 3:15 PM

MODERATOR:

Thomas Rapp, Managing Director, Head of EMEA Fund Finance, Financial Institutions, Wells Fargo EMEA Investment, Financing & Solutions Group

PANELISTS:

Greg Fayvilevich, Global Head of Funds Group, Fitch Ratings

Olivier Renault, Portfolio Manager, Pemberton

Pramit Sheth, Senior Managing Director, Funds, KBRA

Steve Tremblay, Managing Director - Structured Finance, Assured Guaranty

Innovation and New Structures

Fleming & Whittle

3:30 - 4:15 PM

MODERATOR:

Julia Cornett, Partner, Maples Group

PANELISTS:

Michael Durnin, Principal, Ares Management

Helen Griffiths, Head of Structuring, Investec

Pierre Maugüé, Partner, Debevoise & Plimpton

Keenan McBride, Executive Director, Morgan Stanley

Richard Pugh, Partner, Dechert LLP

Key Trends in NAV and Subline Financings

Churchill

3:30 - 4:15 PM

MODERATOR:

James Kinsley, Principal, Carey Olsen

PANELISTS:

Parisa Clovis, Partner, Kirkland & Ellis LLP

Cameron A. Roper, Partner, Proskauer

Stephen Thomas, Head of Finance, Collier Capital

Preqin Update

Fleming & Whittle

4:30 - 5:00 PM

Alex Murray, VP, Head of Real Assets, Preqin

Closing Remarks

Fleming & Whittle

5:00 - 5:05 PM

Kathryn Cecil, Partner, Fried Frank

PLATINUM SPONSORS

APPLEBY

APPLEBY

Appleby is one of the world's leading international law firms, and a market-leader in the Fund Finance sector.

Our experienced Fund Finance team are experts in advising banks and finance providers in the development of sophisticated financing solutions. We regularly act across multiple fund and collateral structures, involving partnerships, LLC's and other corporate vehicles as borrowers and guarantors. The team have unparalleled experience and expertise and have advised on hundreds of subscriptions, NAV, hybrid and asset-backed facilities that have ranged from a hundred million to billions of dollars in subscribed investor commitments.

Appleby holds a strong reputation and history in this market space and is a founding member of the Fund Finance Association.

ashurst

ASHURST LLP

We are pioneers in Fund Finance. As one of the first law firms to advise in this market, we have helped shape its growth and development into the multiple finance products available today. Collectively, our industry-leading partners have over 80 years of experience in structuring and acting for lenders and borrowers on all types of fund financings, including capital call, NAV, preferred equity, SMAs, family offices, co-investments and GP & management facilities. Our unrivalled breadth of experience, commitment to the market and track record of delivering exceptional standards of service means we are a trusted adviser to all the major lenders, GPs, managers and sponsors.

We know funds. Working with our award-winning fund formation, fund tax and fund regulatory practices, we are able to advise and guide the most demanding clients on all aspects relating to funds.

We find solutions that work across borders. Ashurst is a leading global law firm with a rich history spanning over 200 years. With 31 offices in 20 countries, over 484 partners and 1,700 lawyers working across 10 different time zones, we can respond to our clients wherever and whenever they need us. Our network of fund and fund finance experts are one global team that seamlessly and efficiently finds solutions and manages the largest and most complicated cross-border transactions.

Ashurst – ranked Band 1, Legal 500 Fund Finance 2023

BARCLAYS

BARCLAYS

Barclays is a consumer and wholesale bank, supporting individuals and small businesses through our consumer banking services, and larger businesses and institutions through our corporate and investment banking services. Our Corporate and Investment Bank is comprised of the Investment Banking, International Corporate Banking, Global Markets and Research businesses; it provides money managers, financial institutions, governments, supranational organisations and corporate clients with services and advice for their funding, financing, strategic and risk management needs. For further information about Barclays Corporate and Investment Bank, please visit our website www.cib.barclays.

CADWALADER, WICKERSHAM & TAFT

With over 225 years of legal experience, Cadwalader, Wickersham & Taft LLP serves a diverse client base, including many of the world's leading financial institutions, funds, Fortune 500 companies and other leading corporations, and individual private clients. With offices in New York, London, Charlotte and Washington, D.C., Cadwalader offers legal expertise in antitrust, banking, corporate finance, corporate governance, energy, environmental, executive compensation, finance, financial restructuring, health care, intellectual property, litigation, mergers and acquisitions, private equity, private wealth, real estate, regulation, securitisation, structured finance, tax and white collar defense. Cadwalader has more than two decades of experience in fund finance, providing practical, yet cutting edge, advice to a wide variety of financial institutions active in the space. The Fund Finance team regularly represents the agent, lead arrangers and lenders on subscription credit and capital call facilities to real estate, private equity and other investment funds.

CAREY OLSEN
125 YEARS**CAREY OLSEN**

Carey Olsen is a leading offshore law firm. Our fund finance specialists have extensive experience of advising on all types of lending to investment funds in Bermuda, the British Virgin Islands, the Cayman Islands, Guernsey and Jersey.

Our lawyers regularly deal with subscription facilities, GP leverage, co-invest facilities as well as hybrid and NAV based arrangements, with loan sizes ranging from tens of millions to billions of dollars. We work alongside all of the major onshore law firms, accountancy firms and insolvency practitioners on corporate transactions and matters involving our jurisdictions.

Our advice is delivered by an approachable and experienced team of globally-minded lawyers who work in partnership with our clients to help them achieve their objectives. We have the expertise and resources to handle the most complex international transactions combined with a personal approach to business.

**CLIFFORD
CHANCE****CLIFFORD CHANCE LLP**

Clifford Chance is one of the world's pre-eminent law firms, with the depth and range of resources to help our clients across all the major global financial centres. As a single, fully integrated partnership, we pride ourselves on our ability to work seamlessly across national borders and product areas to deliver broad industry expertise and local knowledge. Clifford Chance brings a market-leading fund finance proposition, advising lenders, investors and sponsors/GPs on a wide range of financing options, including capital call / bridge facilities, leveraged NAV facilities and borrowing base deals (including hybrid facilities), along with facilities for general partners, preferred equity arrangements and non-bank financing. Our global funds/ funds formation practice of over 130 lawyers works in tandem with our lending, corporate and regulatory teams to provide a complete fund financing platform for our clients.

Dechert
LLP**DECHERT LLP**

Dechert's Global Finance Practice provides a responsive, interdisciplinary, multi-jurisdictional team to address the complexities of modern finance transactions across categories and geographies. With more than 200 lawyers in the world's major financial centers, our internationally recognized practice provides clients with innovative deal structuring, creative financing strategies and efficient execution. Our clients receive comprehensive solutions for all of their finance needs. By tapping into the breadth of Dechert's expertise, we deliver advice on fund finance, real estate finance, structured finance, leveraged finance and securitization matters. In particular, Dechert advises approximately 100 asset managers in a broad range of financings to their various investment vehicles, including BDCs, closed-end funds, open-end funds, private funds and separately managed accounts.

Deloitte.**DELOITTE**

Deloitte is a leading global provider of audit and assurance, consulting, financial advisory, risk advisory, tax and related services, with approximately 330,000 people in more than 150 countries.

Deloitte's Fund Finance Advisory team is part of the Debt & Capital Advisory business, with >100 people in the UK and >200 across Europe.

The Fund Finance Advisory team at Deloitte has been in existence since 2020 and has grown to seven specialised professionals that focus solely on the Fund Finance market. The team is involved in a range of financings across the full breadth of the Fund Finance market, by product, sector and size.

DEUTSCHE BANK

Deutsche Bank is the leading German bank with strong European roots and a global network. The bank focuses on its strengths in a Corporate Bank newly created in 2019, a leading Private Bank, a focused investment bank and in asset management. Deutsche Bank provides financial services to companies, governments, institutional investors, small and medium-sized businesses and private individuals. The Investment Bank focuses on its traditional strengths in financing, advisory, fixed income and currencies.

Deutsche Bank is an active participant in the fund finance market and has arranged or supported as a member of a wider syndicate a variety of transactions. Deutsche Bank is well-placed as a reliable funding partner particularly on bespoke financing solutions and can help the sponsors achieve a variety of objectives through a wide product suite. Deutsche Bank is a global financial services provider that takes a holistic view of sponsor client relationships and can cater to multiple objectives, asset types and structures. Deutsche Bank's multi-currency and jurisdictional solutions are especially advantageous for EU and US based sponsors seeking to execute on European opportunities or opportunistic add-on acquisitions to platform/portfolio companies and clients are provided with connectivity to Deutsche Bank's overall platform, when desired. Deutsche bank's structuring capabilities are best in class with customizable solutions aimed at achieving goals prescribed by the sponsor. Deutsche Bank has financing capabilities across a broad spectrum of assets, matching the breadth of Deutsche Bank Structured Finance platform.



FRIED FRANK

Fried Frank lawyers are known for their deep understanding of our clients' businesses. We combine responsive, hands-on service with pragmatic legal strategies to ensure that our clients achieve their objectives. We are a team of more than 650 lawyers, located in the key financial centers of New York, Washington, DC, London, Frankfurt, and Brussels. We provide highly commercial guidance on complex matters and sophisticated transactions, and develop effective litigation strategies to address our clients' most critical challenges.

HAYNES BOONE

HAYNES AND BOONE, LLP

Haynes and Boone, LLP is one of the leading U.S. corporate law firms with offices across Texas, in New York, California, Charlotte, Chicago, Denver, Washington D.C., London, Mexico City and Shanghai, representing agent banks in Subscription Financings in Asia, Europe, Latin America and North America. With more than 600 lawyers, Haynes and Boone is ranked among the largest U.S.-based firms by The National Law Journal. The firm was instrumental in developing the structure and documentation for subscription financing in the early 1990s. With over 30 years of industry experience in the global subscription financing market, our Fund Finance Practice has worked through numerous business cycles, taking a multi-disciplinary approach to working with clients and their customers on each transaction, preserving the lender-borrower relationship by conducting all negotiations with an understanding of the fund's business issues, while preserving each fund's relationship with its investors. Our work in the global subscription financing market has been recognized by Private Equity International's Global Annual Awards as one of the top law firms in the "Transactions" category for both Asia and North America. Our global team's focus is a collaborative team approach with an emphasis on partner-led deals. Our team advises on all types of fund finance including subscription financing, NAV/Hybrid, GP support and management fee financings.



KBRA

KBRA is a global full-service rating agency with a mission to set a standard of excellence and integrity. Established in 2010, KBRA remains dedicated to the restoration of trust in credit ratings by creating new standards for assessing risk and by offering timely and transparent ratings. KBRA provides market participants with an alternative solution by delivering in-depth research across various sectors within the United States and European markets. We strive to provide the investment community with the products and tools needed to make informed investment decisions.

KIRKLAND & ELLIS LLP

Kirkland & Ellis provides exceptional service to clients around the world in complex corporate and tax, litigation, intellectual property, restructuring and counseling matters. The Firm offers clients the unsurpassed resources of a large, integrated, multidisciplinary, global team of more than 3,000 attorneys across 19 offices in New York, Chicago, Austin, Beijing, Boston, Brussels, Dallas, Hong Kong, Houston, London, Los Angeles, Miami, Munich, Palo Alto, Paris, Salt Lake City, San Francisco, Shanghai, and Washington, D.C.

Kirkland is a global leader in providing sophisticated advice to investment fund sponsors, institutional investors and other market participants in the alternative investment fund space. Kirkland's strength lies in our unique ability to bring together best-in-class lawyers in all major markets across an extensive, cross-border private equity platform in the United States, Europe and Asia-Pacific. With more than 570 dedicated Investment Funds attorneys, no other law firm matches the breadth, depth and scope of Kirkland's experience in investment funds legal services. In addition to offering one of the largest and most active investment funds practices in the world, Kirkland's platform also includes a dedicated fund finance bench that brings in-depth practical market knowledge to a wide range of financing structures. Since 2017, Kirkland has executed more than 650 fund financing transactions for over 450 clients, including more than 60 NAV facilities, representing approximately \$165 billion in aggregate transaction value.

**LLOYDS BANK**

Lloyds Bank Commercial Banking is part of Lloyds Banking Group, a UK-focused retail and commercial bank with more than 30 million customers across the globe, including 1 million SME customers and 91% of the FTSE 100.

In North America, our Commercial Banking business provides a client-oriented approach for businesses with strong links to the UK. Through our network of relationship managers and by working closely with our Head Office, we offer sound local US and UK knowledge and advise our clients on their businesses and the solutions they need to secure growth and manage risk. We provide them with core banking products such as lending, to develop their activities, drive wealth and job creation, as well as deposits and a range of domestic and international transaction banking services. We are also experts in the Capital Markets and Financial Markets areas, present in the US through our local broker dealer Lloyds Securities Inc.

LOYENS & LOEFF

Loyens & Loeff is a leading law firm with integrated legal and tax practices. We handle all matters relating to investment funds, banking, corporate, private equity, real estate and tax law. Our offices in the Benelux and Switzerland mainly represent banks, financial institutions, investment funds and corporations, operating internationally.

The fund finance team of Loyens & Loeff advises in relation to the structuring of fund finance transactions and the related security packages. Relying on our extensive experience in the structuring of capital call subscription credit facilities, permanent leverage facilities and GP facilities, we handle transactions involving alternative or regulated investment fund borrowers of all types, sizes and asset classes. Major lenders, investment fund managers, sponsors and market players in both the US and European markets count on our expertise regarding fund finance transactions. Our dedicated fund finance team has successfully acted for the most active international banks, arrangers, lenders and fund managers in these markets.

MACQUARIE GROUP

Macquarie Group Limited (Macquarie) is a global financial services group providing clients with asset management, retail and business banking, wealth management, leasing and asset financing, market access, commodity trading, renewables development, specialist advice, access to capital and principal investment. Founded in 1969, Macquarie employs over 19,000 people in 34 markets. At 30 September 2022, Macquarie had assets under management of \$US508.9 billion. For further information, visit www.macquarie.com



MAPLES GROUP

The Maples Group, through its leading international legal services firms, advises global financial, institutional, business and private clients on the laws of the British Virgin Islands, the Cayman Islands, Ireland, Jersey and Luxembourg, and is an independent provider of fiduciary, fund services, regulatory and compliance, and entity formation and management services. Combining the Maples Group's leading finance and investment funds capability, the Group's Fund Finance team has widespread experience in advising on all aspects of fund finance and related security structures for both lenders and borrowers. The Maples Group distinguishes itself with a client-focused approach, providing solutions tailored to their specific needs. Its global network of lawyers and industry professionals are strategically located in the Americas, Europe, Asia and the Middle East to ensure that clients gain immediate access to expert advice and bespoke support, within convenient time zones. For more information, please visit: maples.com.



MAYER BROWN LLP

Mayer Brown, the founding sponsor of the Annual Subscription Facility and Fund Finance Symposium, is a global legal services organization advising clients across the Americas, Asia and Europe. Our presence in the world's leading markets enables us to offer clients access to local market knowledge combined with global reach. Mayer Brown's finance platform is based on the Firm's global position and our balanced and integrated practice, which encompasses all the focused skill sets that our clients demand— from cross-border acquisition finance and international capital markets work to project finance, structured finance, and derivatives.

Mayer Brown is a market leader and has acted as Adviser to Lenders and Funds on over 500 subscription credit facilities in the last two years. The firm has relationships with every major US lender along with the majority of active lenders in the European and Asian markets. The team has led transactions funded by balance sheet lenders and commercial paper conduits as well as large syndicated facilities to accommodate various types of insurance companies. Its lawyers are experienced documenting the full suite of fund and portfolio-level financings including subscription-backed credit facilities, NAV facilities, private placements, equity commitment facilities, hybrid facilities, open-end fund facilities, management fee credit lines and an assortment of leveraged asset level transactions.



MUFG INVESTOR SERVICES

MUFG Investor Services is a leading asset servicing provider for the global alternative investment management industry. From 14 locations around the world, MUFG Investor Services, through its suite of solutions, helps clients mitigate risk, execute seamlessly, and increase efficiencies in their pre- and post-trade operations. With over \$770 billion in assets under administration, MUFG Investor Services is one of the top fund administrators globally. Its nearly 500 clients represent hedge funds, asset managers, private equity, private debt, real estate, infrastructure, fund of funds, and more, and benefit from a broad range of additional solutions including fund financing, foreign exchange, custody, trustee services, depository, middle-office outsourcing, securities lending, and other banking services. MUFG Investor Services is a division of Mitsubishi UFJ Financial Group, Inc (MUFG) one of the largest banks in the world with \$3.3 trillion in assets. To learn more, please visit us at www.mufginvestorservices.com.



OGIER

Recommended as a top-tier firm by Legal 500, Ogier has advised on fund finance since the inception of the funds industry, regularly acting for banks, financial institutions, funds and sponsors on a full range of fund finance transactions. The firm's specialists are highly accomplished and many of its lawyers have been actively involved in drafting key legislation that underpins the fund structures in BVI, Cayman Islands, Guernsey, Ireland, Jersey and Luxembourg, making Ogier the only firm to advise on those six laws. The diverse nature of Ogier's practice provides its team with valuable insight and understanding of the funds market and the legal and commercial issues relevant to borrowers and lenders alike. With a growing team of more than 1,000 people across 12 of the world's most distinguished international finance centres, Ogier's 'hands-on' partner-led teams ensure a consistent approach, while providing responsive and practical advice.

Visit www.ogier.com to read more about Ogier's fund finance offering and see the global team.

PAUL HASTINGS

In today's world of transformative change, our purpose is clear — to help our clients and people navigate new paths to growth.

Founded in 1951, Paul Hastings has grown strategically to anticipate and respond to our clients' needs in markets across the globe. Our innovative approach and unmatched client service has helped guide our journey to becoming one of the world's leading global law firms in such a short time.

We have a strong presence throughout Asia, Europe, Latin America, and the U.S. We offer a complete portfolio of services to support our clients' complex, often mission-critical needs—from structuring first-of-their-kind transactions to resolving complicated disputes to providing the savvy legal counsel that keeps business moving forward.

Please visit www.paulhastings.com for more information.



RBS INTERNATIONAL

We specialise in helping institutional clients look after their money and manage risk. This includes transactional banking, fund financing, liquidity and risk management, and depositary services (through separate legal entities). We're based in Jersey, Guernsey, London, Luxembourg, Gibraltar and the Isle of Man so our clients get personal, tailored support from a local expert. And our multi-currency online banking platform, eQ, lets them move and manage money the same way they do their personal banking.

Our clients include alternative investment fund managers, asset managers, fund administrators and corporate service providers. With our culture of restless innovation, we work to make banking easy. We're focused on delivering all the services our clients need, where and when they need them.



REED SMITH

Reed Smith is a market-leading international law firm specialising in funds finance. With more than 1,700 lawyers across 31 offices, we advise lenders and funds on capital call/subscription lines, NAV and asset-backed facilities, secondary funds facilities, hybrid facilities, co-investment and GP/manager support facilities and other fund liquidity facilities in Europe, the U.S., Asia and the UAE. We have one of the largest team of funds finance lawyers globally and provide specialist advice on the new and developing products in this area. Reed Smith has particular capability with financings of direct lending, secondary and PE funds. Reed Smith's funds finance team sits within our Financial Industry Group that contains more than 210 lawyers who provide dedicated multi-jurisdictional services to clients in the financial sector focusing on finance, funds and investment management, regulatory, tax, litigation and commercial restructuring and bankruptcy.



SIMMONS & SIMMONS LLP

Collaborative, agile and partner-led: that's Simmons & Simmons. A law firm that challenges, creates new possibilities and offers opinion not just option. A law firm that acts as your business partner and works with you, not for you.

We focus on four highly regulated sectors using our specialist skills to understand your business, and the forces at play around it. All grounded in exceptional knowledge of the legal detail. This is how we consistently deliver smarter, more efficient ways to tackle our clients' most complex challenges.

Our International Funds Finance practice is no exception. Operating across the UK, Europe, Middle East and Asia, we're recognised for both technical excellence and outstanding commerciality. The team advises banks, hedge fund managers, private equity funds, real estate funds and investment fund managers in connection with a wide range of financings involving many different fund asset classes. As both the Asset Management/ Investment Funds and Financial Institutions sectors are key areas of focus for our firm, whether we are acting for a lender or a borrower, we are able to deliver an efficient and high calibre service.

SIMPSON THACHER & BARTLETT LLP

Simpson Thacher & Bartlett LLP (www.simpsonthacher.com) is one of the world's leading international law firms. The Firm was established in 1884 and today has more than 1,000 lawyers. Building on over 135 years of experience, the Firm has played a substantial role in many of the most complex and noteworthy transactions and matters of the last decades. Headquartered in New York with offices in Beijing, Brussels, Hong Kong, Houston, London, Los Angeles, Palo Alto, São Paulo, Tokyo and Washington, D.C., the Firm provides coordinated legal advice and transactional capability to clients around the globe.

The Firm offers a market-leading fund finance practice with deep experience providing fund- and asset-level leverage solutions for private equity, real estate, investment, special situations and infrastructure funds. Complementing the Firm's preeminent private funds practice, our global fund finance team represents clients across a broad spectrum of transactions encompassing all aspects of the investment management business.



SMBC

SMBC Group is a top-tier global financial group. Headquartered in Tokyo and with a 400-year history, SMBC Group offers a diverse range of financial services, including banking, leasing, securities, credit cards, and consumer finance. The Group has more than 140 offices and 86,000 employees worldwide in nearly 40 countries. Sumitomo Mitsui Financial Group, Inc. (SMFG) is the holding company of SMBC Group, which is one of the three largest banking groups in Japan. SMFG's shares trade on the Tokyo, Nagoya, and New York (NYSE: SMFG) stock exchanges. As of June 30, 2022, its total assets were \$1.97 trillion.



STANDARD CHARTERED BANK

We are a leading international banking group, with a presence in 59 of the world's most dynamic markets, and serving clients in a further 83. Our purpose is to drive commerce and prosperity through our unique diversity, and our heritage and values are expressed in our brand promise, here for good.

Standard Chartered PLC is listed on the London and Hong Kong Stock Exchanges.

For more stories and expert opinions please visit Insights at sc.com. Follow Standard Chartered on Twitter, LinkedIn and Facebook.



TRAVERS SMITH LLP

It is not just law at Travers Smith. Travers Smith treats its clients' business and challenges as its own. Wherever in the world you, or your ambitions lie, the firm will work as one of their team to get things done. We have been an active participant in the European fund finance space for over 25 years and frequently advise market participants both providing and seeking finance on a wide range of financing structures including subscription facilities, NAV and hybrid facilities, secondaries facilities, GP support / co-invest facilities and management fee facilities.



VALIDUS

Validus is a leading independent financial services firm, providing market risk management, fund finance advisory and technology solutions to the alternative investment industry. Our clients have more than \$2 trillion in combined assets under management.

Since 2010 our core expertise has been to deliver effective and efficient risk management solutions for alternative investment firms, mitigating exposures such as foreign currency or interest rates. Our award winning service also includes turnkey solutions to the operational challenge of implementing, managing and monitoring hedging programmes, through dedicated resources and proprietary technology.

We also provide expert advice and resources to sponsors seeking to establish, refinance and re-negotiate fund finance facilities. Our unique position in the industry enables us to help clients navigate and benchmark the market, design and evaluate optimal structures, and negotiate terms to best meet their requirements.



WELLS FARGO BANK

About Wells Fargo Wells Fargo & Company (NYSE: WFC) is a leading financial services company that has approximately \$1.9 trillion in assets, proudly serves one in three U.S. households and more than 10% of small businesses in the U.S., and is a leading middle market banking provider in the U.S. We provide a diversified set of banking, investment and mortgage products and services, as well as consumer and commercial finance, through our four reportable operating segments: Consumer Banking and Lending, Commercial Banking, Corporate and Investment Banking, and Wealth & Investment Management. Wells Fargo ranked No. 41 on Fortune's 2022 rankings of America's largest corporations. In the communities we serve, the company focuses its social impact on building a sustainable, inclusive future for all by supporting housing affordability, small business growth, financial health and a low-carbon economy.

GOLD SPONSORS



17 CAPITAL

17Capital is the go-to global source of strategic finance for investors in private equity. It specializes in providing non-dilutive capital to high-quality private equity management companies, funds, and institutional investors as part of their toolkit for value creation and portfolio management.

17Capital offers portfolio finance across the capital structure, providing a broad range of financing options. Investments are structured to support clients' objectives, while keeping the interests of GPs and LPs aligned.

Since inception, 17Capital has raised over \$11 billion and has deployed over \$9 billion across 88 investments. In July 2022, 17Capital announced the completion of Oaktree's acquisition of a majority interest in 17Capital. The partnership will give 17Capital access to Oaktree's deep global network. Following the closing of the transaction, 17Capital, will continue to operate as an independent business, with its own product offerings and investment, marketing, and support teams.



ABRND

abrnd operates in over 30 locations worldwide and manages £376.1 billion of assets for our clients.* By offering investment expertise across all key asset classes, regions and markets, we help our clients to capture investment potential wherever it arises. We combine fundamental research, thematic thinking, sustainable best practice and extensive on-the-ground analysis. This helps us to find the most future-fit investment opportunities, globally. We offer clients access to all major areas of private credit in Europe, including commercial real estate debt, infrastructure debt, corporate private placement debt, direct (mid-market) lending and syndicated loans. We manage close to £11 billion of capital across these strategies



ALLEN & OVERY LLP

Allen & Overy is a global law firm that helps the world's leading businesses to grow, innovate and thrive. For almost a century, we have built a reputation for our commitment to think ahead and bring original solutions to our clients' most complex legal and commercial challenges.

We are where you are. Based across 31 countries in Europe, the Americas, the Middle East, Africa and Asia, our global fund finance practice has extensive experience in advising investment fund managers, banks, agents and alternative lenders on a broad range of upstream and downstream financing solutions.

We help clients find solutions. Our fund finance team brings in-depth technical and commercial knowledge to a wide range of lending structures across the fund finance spectrum – including subscription facilities, NAV, hybrid and asset-backed facilities, secondaries facilities and GP & management fee facilities. Working together with top tier specialist lawyers in our fund formation, real asset (including private equity, real estate, transportation and infrastructure), tax and regulatory teams, we offer an exceptional breadth of experience and local expertise – and as a result, our clients benefit from our clear understanding of the current legal and commercial issues relevant to all parties in fund finance transactions.



ALLVUE SYSTEMS

Allvue is a leading provider of technology for investment managers in the private capital and credit markets industry. Its mission is to empower superior investment decisions by pairing modern cloud-based software solutions with capabilities across multiple asset classes. Allvue's software solutions serve the entire investment lifecycle and are seamlessly integrated to provide a comprehensive product suite, serving investment managers of all sizes worldwide. With a commitment to innovation and a focus on multiple asset classes, Allvue's software solutions allow its clients to operate and grow their businesses more effectively by automating manual processes, improving data accuracy and consistency across workflows, and delivering enhanced analytics.



ANZ

Headquartered in Melbourne and with a long-term AA- credit rating, Australia and New Zealand Banking Group Limited (ANZ) has a banking heritage spanning more than 180 years in Australia and New Zealand and an established on the ground presence in 15 Asian markets.

As clients look to capitalise on the movement of money and goods across Asia Pacific, they find in us a strong banking partner who can help them manoeuvre the rapidly changing business and regulatory landscape, while effectively managing liquidity, risk and investments.

We connect clients to opportunities centred around trade and capital flows into and within Asia Pacific.



ASSURED GUARANTY

With \$11 billion in claims-paying resources and over three decades of structured finance and infrastructure finance experience, Assured Guaranty is the world's leading provider of financial guaranty insurance. Its U.S., U.K. and French insurance subsidiaries work with banks, investors, issuers, arrangers and their advisors to provide cost-effective credit enhancement for capital market financings in developed markets around the world. Assured Guaranty guarantees timely principal and interest payments, improving the creditworthiness, potential marketability and market liquidity in both new and secondary markets for consumer and commercial asset-backed securities, collateralized loan obligations (CLOs), infrastructure financings and subscription finance. Assured's guaranty enables risk transfer in public or private transactions for banks, insurance companies and asset managers to optimize the risk profile, internal exposure limits and capital consumption of existing and prospective portfolio exposure. Another subsidiary, Assured Investment Management, provides asset management services and is a prominent CLO manager. Learn more at AssuredGuaranty.com.



BANK OF AMERICA

Bank of America is one of the world's leading financial institutions, serving individual consumers, small and middle-market businesses and large corporations with a full range of banking, investing, asset management and other financial and risk management products and services. The company provides unmatched convenience in the United States, serving approximately 67 million consumer and small business clients with approximately 3,900 retail financial centers, approximately 16,000 ATM and award-winning digital banking with approximately 56 million verified digital users. Bank of America is a global leader in wealth management, corporate and investment banking and trading across a broad range of asset classes, serving corporations, governments, institutions and individuals around the world. Bank of America offers industry-leading support to approximately 3 million small business households through a suite of innovative, easy-to-use online products and services. The company serves clients through operations across the United States, its territories and approximately 35 countries. Bank of America Corporation stock (NYSE: BAC) is listed on the New York Stock Exchange.



COMMONWEALTH BANK OF AUSTRALIA (CBA)

As one of Australia's most recognised brands, Commonwealth Bank of Australia (CBA) is a leading provider of personal banking, business and institutional banking and share broking services in Australia. CBA has a strong balance sheet, with total assets exceeding \$A1,091.65 Billion (as at 30 June 2021).

Headquartered in Sydney, Australia, and with offices in Europe, the US and Asia Pacific, CBA is strategically positioned to work with clients across global markets, while connecting non-Australian clients to opportunities both in Australia and around the world. As custodian of Australia's largest customer transactional data set, CBA can connect global clients to Australian opportunities backed by data-generated insights. Our scale enables us to unlock alternative pools of liquidity and capital, with strong execution capabilities complemented by a network of corporate referrals and diverse international expertise.

The Institutional Banking & Markets division offers a full range of capital raising solutions and financial markets capabilities, as well as transactional and risk management products and services.

DEBEVOISE & PLIMPTON LLP

Debevoise & Plimpton LLP is a premier law firm with market-leading practices and a global perspective. Approximately 800 lawyers work in nine offices across three continents, within integrated global practices, serving clients around the world.

The firm has extensive experience in all aspects of fund-level financing transactions for different types of investment funds and their managers. It has been regularly representing sponsors for more than a decade in a broad range of transactions, including subscription credit facilities, leveraged portfolio acquisition and other asset-based financings, hybrid facilities, management company liquidity facilities and co-investment facilities.

Debevoise's fund finance practice is global in nature, with strong teams in the U.S., Europe and Asia advising an international client base.

大成 DENTONS

DENTONS

Dentons is designed to be different. The challenges that our clients are navigating and the opportunities they are advancing are changing at an accelerating pace. We are a law firm that embraces change and can help you GROW, PROTECT, OPERATE and FINANCE your organization.

This is why Dentons is organized to offer more than legal insight; we help you find business solutions, in a seamless fashion, across the globe. WWW.DENTONS.COM

Fitch Ratings

FITCH RATINGS

Fitch Ratings is a leading provider of credit ratings, commentary, and research. Dedicated to providing value beyond the rating through independent and prospective credit opinions, Fitch Ratings offers global perspectives shaped by strong local market experience and credit market expertise. The additional context, perspective, and insights we provide help investors to make important credit judgments with confidence.

Fitch Group is a global leader in financial information services with operations in more than 30 countries. Fitch Group is comprised of: Fitch Ratings, a global leader in credit ratings and research; Fitch Solutions, a leading provider of credit market data, analytical tools and risk services; Fitch Learning, a preeminent training and professional development firm; and Sustainable Fitch, the first global ESG Ratings solution for all asset classes at an entity and instrument level.

With dual headquarters in London and New York, Fitch Group is owned by Hearst.

For additional information, please visit fitchratings.com.

ING

ING

ING is a global financial institution with a strong European base, offering banking services through its operating company ING Bank. The purpose of ING Bank is: empowering people to stay a step ahead in life and in business. ING Bank's more than 58,000 employees offer retail and wholesale banking services to customers in over 40 countries.

Sustainability is an integral part of ING's strategy, evidenced by ING's leading position in sector benchmarks. ING's Environmental, Social and Governance (ESG) rating by MSCI was affirmed 'AA' in September 2022. As of August 2022, Sustainalytics considers ING's management of ESG material risk to be 'strong', and in June 2022 ING received an ESG rating of 'strong' from S&P Global Ratings. ING Group shares are also included in major sustainability and ESG index products of leading providers Euronext, STOXX, Morningstar and FTSE Russell.

INTESA SANPAOLO

The Intesa Sanpaolo Group is one of the top banking groups in Europe (48.6 billion euro of market capitalisation(1)), with a significant ESG commitment, a world-class position in Social Impact and strong focus on climate.

Intesa Sanpaolo is the leader in Italy in all business areas (retail, corporate, and wealth management). The Group offers its services to 13.6 million customers through a network of over 3,600 branches well distributed throughout the country with market shares no lower than 12% in most Italian regions.

IMI Corporate & Investment Banking is a division of Intesa Sanpaolo and a global partner serving Corporates, Public Finance and Financial Institutions, on a national and international basis. The Division's offer includes the following products and services: Commercial Banking, Transaction Banking, Structured Finance, Investment Banking and Capital Markets.



INVESTEC

We are a leading provider of banking, lending, hedging & advisory solutions for private equity funds across the full fund lifecycle. Our expertise, growth mindset and collaborative approach enables us to support our clients in achieving their ambitions. Partnering with them to optimise the value that they create as professionals and the long term worth that they generate as individuals.



MACFARLANES

We are a distinctive London-based law firm with a unique combination of services built and shaped around the needs of our clients. Our unrivalled blend of expertise, agility and culture means we have the flexibility to meet their most challenging demands and adapt to the changing world around us. While many of our services can be found at other firms, the mix cannot.

We work on an international basis with the top independent law firms around the world. This strong international network gives clients choice and enables us to provide them with the highest possible level of service.

We recruit people to build careers for the long term. We know each other personally which means we work together with more cohesion, and less formality. Our culture is thoughtful, challenging and supportive, and we are a place where everyone, at whatever level, can thrive.



MORGAN STANLEY

Morgan Stanley has earned a worldwide reputation for excellence in financial advice and market execution. With offices in more than 41 countries, the people of Morgan Stanley are dedicated to providing our clients the finest thinking, products and services to help them achieve even their most challenging goals.



NATIONAL AUSTRALIA BANK

"National Australia Bank (NAB) is a leading Australian bank. Our global Corporate and Institutional Bank serves Financial Institutions and Corporates through our offices in Australia, Asia the US and Europe. The New York based team provide full relationship services, originating and executing product solutions with a focus on infrastructure, sustainability and investor solutions. We work with some of the leading participants in the infrastructure sector – leading deals across all market segments including renewables, energy, resources, transport and commodities – and coordinate closely across fund and asset level exposures. We have a dedicated Funds business which operates globally through US, UK, Asia and Australia which provides banking and markets solutions for asset managers and financial sponsors. We are an agent for subscription financing and credit facilities for private and publicly listed funds."



NLC

NLC is a leading alternative fund finance lender. NLC focuses on providing General Partners with seamless, flexible, and cost-effective financing solutions across the fund finance product spectrum with an increased focus on subscription (capital call) financing. NLC's diverse capital base of global institutional investors, is expanding the fund financing market by creating additional capacity and removing traditional banking constraints. For more information please, visit NLC.CO.UK or email us on CONTACT@NLC.CO.UK



NOMURA

Nomura is a global financial services group with an integrated network spanning over 30 countries. By connecting markets East & West, Nomura services the needs of individuals, institutions, corporates and governments through its three business divisions: Retail, Wholesale (Global Markets and Investment Banking), and Investment Management. Founded in 1925, the firm is built on a tradition of disciplined entrepreneurship, serving clients with creative solutions and considered thought leadership. For further information about Nomura, visit www.nomura.com.



PROSKAUER

Proskauer's fund finance practice represents private funds, regulated investment companies, fund investors and lenders on a full range of financing transactions in the U.S. and the U.K. Our team curates innovative solutions at all levels of the capital structure, on matters involving secured and unsecured subscription/capital call facilities, NAV facilities, secondaries acquisitions, and GP, management and co-investment facilities. We have helped clients with leveraged secondary transactions for some of the world's largest secondary funds, warehouse facilities for middle market lending joint ventures, NAV facilities backed by life insurance policies and hybrid facilities. We also employ a network of seasoned professionals across the firm, enabling us to understand any fund vehicle and appreciate the deal points that concern all parties.



STATE STREET

State Street Corporation (NYSE: STT) is one of the world's leading providers of financial services to institutional investors including investment servicing, investment management and investment research and trading. With \$35.7 trillion in assets under custody and/or administration and \$3.3 trillion* in assets under management as of September 30, 2022, State Street operates globally in more than 100 geographic markets and employs approximately 41,000 worldwide. For more information, visit State Street's website at www.statestreet.com.

SILVER SPONSORS



ADDLESHAW GODDARD

AG is an international law firm, working from 17 offices around the world in the UK, Europe, the Middle East and Asia. By combining our own offices, our business groups and a network of preferred firms we offer a full range of legal services in over 200 jurisdictions.

We have a 3 partner-led (with over 50 years of combined experience) dedicated and collaborative Funds Finance team, one of the largest Funds Finance teams in the market and is a go-to firm for significant and complex cross-border Funds Finance transactions.

Few firms match the 360 degree breadth of practice AG brings to private investment fund managers and investors and their funders. The team works closely with AG's Investment Management, Structured Finance and Securitisation teams which comprise of specialists in funds formation, tax and structuring, regulation and corporate and is one of the largest and most recognised practices in the UK.



ARENDE & MEDERNACH

We are lawyers, regulatory consultants, business advisors, tax, corporate and funds services experts. We bridge the gap between legal advice and its implementation. We take an integrated approach to solving your business issues. We are Arendt - Luxembourg's leading legal, tax and business services firm.

Arendt & Medernach is the leading independent business law firm in Luxembourg. The firm's international team of 400 legal professionals represents clients in all areas of Luxembourg business law, with representative offices in Hong Kong, London, New York and Paris. Our service to clients is differentiated by the end to end specialist advice we offer, covering all legal, regulatory, taxation and advisory aspects of doing business in Luxembourg.

ARTHUR COX

ARTHUR COX

Arthur Cox LLP is one of Ireland's leading law firms. We have been at the forefront of developments in the legal landscape here for over 100 years, establishing one of the largest and most innovative law firms in the country – a firm that stands at the front of the industry. We are an "all-island" firm with offices in Dublin and Belfast. We also have offices in London, New York, and San Francisco. Our practice encompasses all aspects of corporate and business law.

With over 530 legal staff and a total headcount of 740, we provide a comprehensive service to an international client base ranging from multinational organisations, banks, and financial institutions and established global leaders to government agencies and new players in emerging industry sectors.

Our story has been defined by our progressive outlook. For over 100 years, we have led the way in the legal field in Ireland, and have continuously worked to strive towards our goals. For our clients, we work to deliver the best service and support. With an independent, entrepreneurial spirit of innovation leading the way.



BANK OF CHINA

Established in 1912, Bank of China is the Bank with the longest continuous operation among all Chinese banks. As China's most globalised and integrated bank, Bank of China has a well-established global service network with institutions set up across the Chinese mainland as well as in 62 countries and regions. It has established an integrated service platform based on the pillars of its corporate banking, personal banking, financial markets and other commercial banking business, which covers investment banking, direct investment, securities, insurance, funds, aircraft leasing and other areas, providing its customers with a comprehensive range of financial services.

Established in 1929, Bank of China London Branch is the first ever overseas Chinese financial institution in global financial centers. Its history in the UK perfectly illustrates the international journey of China's modern financial services industry. Over the past 94 years, Bank of China has expanded steadily in the UK and has become the first choice for both Chinese 'going-out' customers and local UK customers seeking to establish relationships with China, with branches in the City of London, London Chinatown, Manchester, Birmingham, and Glasgow across the UK. It is taking a leading role amongst UK based Chinese financial institutions and is one of the mainstream foreign banks in the European market.



GOLDMAN SACHS

The Goldman Sachs Group, Inc. is a leading global investment banking, securities and investment management firm that provides a wide range of financial services to a substantial and diversified client base that includes corporations, financial institutions, governments and individuals.

Founded in 1869, the firm is headquartered in New York and maintains offices in all major financial centers around the world.

Our focus is on delivering sustainable, long-term returns for our stakeholders through a strategy that revolves around our clients.

Our Business Principles, the foundation of our culture of partnership, client service, integrity and excellence, are fundamental to our long-term sustainability and success.



GOODWIN PROCTER LLP

At Goodwin, we partner with our clients to practice law with integrity, ingenuity, agility, and ambition. Our 2,000+ lawyers across Europe, the United States and Asia excel at fund formation, complex transactions, high-stakes litigation and world-class advisory services in the private equity, technology, life sciences, real estate, and financial industries. In the fund finance space, we represent sponsors, lenders and other market participants on management financings, subscription lines, NAV facilities, secondaries transactions and an array of other innovative liquidity solutions. The firm's unique combination of deep experience serving both the innovators and the investors in a rapidly-changing, technology-driven economy sets Goodwin apart. To learn more, visit, us at www.goodwinlaw.com and follow us on Twitter, LinkedIn and Instagram.



HSBC INNOVATION BANKING



MCDERMOTT WILL & EMERY

McDermott Will & Emery partners with leaders around the world to fuel missions, knock down barriers and shape markets. With 20+ locations globally, our team works seamlessly across practices, industries and geographies to deliver highly effective—and often unexpected—solutions that propel success. More than 1,400 lawyers strong, we bring our personal passion and legal prowess to bear in every matter for our clients and the people they serve.



MIZUHO BANK

Headquartered in London, our business in EMEA represents our global promise of trust and integrity and a way of doing business that reflects our belief in long-term sustainable growth for the mutual benefits of the societies in which we operate. Mizuho's European presence dates back to 1952. We have continued to grow ever since, spreading throughout the EMEA region. EMEA is a key part of the Group's global ambitions and going forward we are committed to our presence in this region and are well positioned to increase it. To learn more about Mizuho EMEA's business, values, and ethical commitments, and the entities it comprises, visit [www. https://www.mizuhogroup.com/emea/](https://www.mizuhogroup.com/emea/)

Mizuho Financial Group is one of the largest financial institutions in the world, offering comprehensive financial and strategic services through its subsidiaries. The group has approximately 900 offices and 60,000 employees worldwide in nearly 40 countries throughout the Americas, EMEA and Asia. As of December 31, 2021, its total assets were approximately \$2 trillion. Learn more about Mizuho Financial Group at www.mizuhogroup.com.



MOURANT

Our market-leading funds team spans time-zones and has an outstanding international reputation in offshore investment funds, working across a wide range of alternative fund asset classes – traditionally real estate, private equity, credit and hedge funds. We advise on the formation, structuring and regulation of investment funds in the Cayman Islands, the BVI, Jersey and Guernsey, and our lawyers provide ongoing legal advice to offshore funds and their managers and investors.

Our 'one firm' approach means that working together with clients we deliver seamless, objective and commercially grounded advice on the comparative advantages and disadvantages of the leading offshore fund jurisdictions. Our team exercises true commercial judgment in delivering advice often going the extra mile, with a personal approach, and forming genuine partnerships with our clients and their advisers. Clients benefit from our teams working together and making things happen in this way, resulting in deals being delivered on time and within budget.

Visit www.mourant.com to find out more.



NATIXIS SA

Natixis Corporate & Investment Banking is a leading global financial institution that provides advisory, investment banking, financing, corporate banking and capital markets services to corporations, financial institutions, financial sponsors and sovereign and supranational organizations worldwide.

Our teams of experts in around 30 countries advise clients on their strategic development, helping them to grow and transform their businesses, and maximize their positive impact. Natixis CIB is committed to aligning its financing portfolio with a carbon neutrality path by 2050 while helping its clients reduce the environmental impact of their business.

As part of the Global Financial Services division of Groupe BPCE, the second largest banking group in France through the Banque Populaire and Caisse d'Épargne retail networks, Natixis CIB benefits from the Group's financial strength and solid financial ratings (Standard & Poor's: A, Moody's: A1, Fitch Ratings: AA-, R&I: A+).



RABOBANK

Rabobank is a cooperative bank with a mission. Together with our stakeholders, we have been dedicated to creating a future-proof society and tackling major societal challenges for 125 years. In the Netherlands, we serve retail and corporate clients; globally we focus on the food and agriculture sector. Our starting point is: together we can achieve more than we could individually. We now operate in 38 countries, with over 43,000 employees. In the Netherlands, we serve retail and corporate clients with a wide range of financial products and services. Across the world, we focus on entrepreneurs and companies in the food and agriculture sectors. The Rabobank Group also includes BPD, Obvion and DLL, with which we offer our clients housing and leasing solutions.

SCOTIABANK

Scotiabank is a leading bank in the Americas. Guided by our purpose: “for every future”, we help our customers, their families and their communities achieve success through a broad range of advice, products and services, including personal and commercial banking, wealth management and private banking, corporate and investment banking, and capital markets. With a team of over 90,000 employees and assets of over \$1.3 trillion (as at January 31, 2023), Scotiabank trades on the Toronto Stock Exchange (TSX: BNS) and New York Stock Exchange (NYSE: BNS).

Global Banking and Markets (GBM) provides corporate clients with lending and transaction services, investment banking advice and access to capital markets. A full-service wholesale bank in the Americas, GBM serves clients across Canada, the United States, Latin America, Europe, and Asia Pacific. For more information, please visit <https://www.gbm.scotiabank.com/en.html>.

**SUMITOMO MITSUI TRUST BANK**

Sumitomo Mitsui Trust Bank, Limited (“SuMi Trust”) is the largest and strongest of Japan’s trust banks and was originally established in 1925.

It provides a wide range of banking, fiduciary, custody and other business services including asset management, corporate and structured financing, Japanese real estate brokerage and retail banking in the domestic market.

Internationally, SuMi Trust has branches in a number of major global financial centres, where it is primarily focused on banking business. As such, SuMi Trust is a regular provider of corporate and structured financings to its clients. In line with its trust bank heritage, it often works closely with its Japanese investor partners to bring enhanced funding solutions to its customers.

**TRAVERS THORP ALBERGA**

TraversThorp Alberga is a boutique Cayman Islands and British Virgin Islands law firm comprised only of the most experienced lawyers from both jurisdictions and modelled for the post-financial crisis environment. We specialize in highly technical structuring involving complex securities and regulatory issues. Our partners provide incisive and highly effective advice to the highest standard on all types of offshore entities including hedge funds, private equity, corporate and partnership vehicles, asset and structured finance, cryptocurrencies, ICOs/IEOs/STOs, capital markets, general corporate and commercial matters and private client. We advise across a broad- range of fund finance products with particular emphasis on subscription financing, asset backed financing (NAV facilities), hybrid, GP support and co-invest facilities including financings via umbrella facilities and separately managed accounts. We are highly experienced in financing diverse investments, including real estate, distressed assets, loan portfolios and acquisition of assets located in emerging markets. We advise from our offices in Grand Cayman, the British Virgin Islands, Hong Kong, London, New Zealand and Australia.

WESTPAC BANK CORPORATION

Westpac institutional Bank (WIB) delivers a broad range of financial products and services to corporate, institutional and government customers operating in, or with connections to, Australia and New Zealand. WIB operates through dedicated industry relationship and specialist product teams, with expert knowledge in financing, transactional banking, and financial and debt capital markets. Customers are supported throughout Australia and via branches and subsidiaries located in New Zealand, the US, UK and Asia. WIB works with all the Group’s divisions in the provision of markets’ related financial needs including foreign exchange and fixed interest solutions.

BRONZE SPONSORS



BRICKFIELD RECRUITMENT

Brickfield Fund Finance Recruitment is the only talent acquisition service dedicated to the global fund finance sector. Our in-depth knowledge of the fund finance market, complimented by a diligent and discreet personal approach, gives us an unparalleled ability to bring the right people together.

Founded in 2018, Brickfield plays a key role in facilitating moves at all levels within the fund finance industry, as well as bringing brand new talent into the industry to assure its long-term capacity for growth.

Brickfield also provides strategic counsel to banks, law firms, funds and alternative lenders facing challenges in attracting high quality candidates within this competitive recruitment market, advising on fund finance industry specifics and key guidance on issues such as base salary expectations, bonus benchmarking and brand reputation.

Brickfield is the exclusive publisher of the Fund Finance Bankers Compensation Report which provides comprehensive US and UK salary and bonus data, as well as in-depth thought leadership and analysis on key recruitment and career-related issues from leading fund finance industry players. The latest 2022 edition of the Report is available free with registration at Brickfield's website.



BURGISS

Burgiss is a global, market-leading provider of data and analytics solutions for investors. With over 30 years of expertise in alternative investments, we offer unrivaled data, analytics, and transparency that enable asset owners, asset managers, and financial intermediaries to evaluate and manage complex portfolios. Burgiss' solutions serve 1,000+ clients in more than 30 countries, delivering data that represents over \$15 trillion in assets.

With offices throughout the Americas, EMEA, and Asia Pacific, we leverage our network and expertise so that we can service our clients by focusing on their varying needs across regions.

Linklaters

LINKLATERS

Linklaters is a leading international law firm with more than 3,000 lawyers across 31 offices in Europe, the Americas, the Middle East, Africa and Asia.

We have one of the broadest, deepest and most globally integrated funds practices of any law firm. Our global finance practice is at the top of the market and, within it, our fund finance team regularly advises across the full range of fund-based lending structures including subscription facilities, NAV and hybrid facilities, GP financings and co-investment loans. Our team is experienced across all asset classes, including private equity, emerging market, large buy-out and mid-market funds, debt, infrastructure, real estate, energy and fund of funds.

The team's experience in acting not only for arranging banks and lenders but also for, sponsors, asset managers and credit-enhancers across a wide range of sectors means clients benefit from an incisive, forward-thinking approach to fund finance transactions.

MATHESON

Matheson services the legal needs of internationally focused companies and financial institutions doing business in and from Ireland. Our clients include over half of the world's 50 largest banks, 7 of the world's 10 largest asset managers, 7 of the top 10 global technology brands and we have advised the majority of the Fortune 100 companies. Our Finance and Capital Markets team consists of more than 50 lawyers and advises financial institutions and corporations involved in arranging and executing all forms of finance and capital markets transactions in Ireland. We act for all of the major Irish banks and financial institutions, corporate borrowers and many of the world's leading international banks, investment managers and investment funds, securities and derivatives trading houses, broker dealers, insurance companies, alternative finance providers, supranational organisations, rating agencies, trustees and other financial services firms in relation to their lending, borrowing, finance and capital markets transactions and arrangements.

Morgan Stanley

PRIVATE WEALTH MANAGEMENT

MORGAN STANLEY PRIVATE WEALTH MANAGEMENT

Morgan Stanley (NYSE: MS) is a leading global financial services firm providing investment banking, securities, investment management and wealth management services. With offices in more than 41 countries, the Firm's employees serve clients worldwide including corporations, governments, institutions and individuals. For more information about Morgan Stanley, please visit www.morganstanley.com.

Nordea

NORDEA

The Nordea Fund Finance team was established in 2014 and is a dedicated team of experienced fund finance professionals within our Leveraged Finance division. The team supports Nordea's clients within the Private Capital segment with financing solutions across various strategies including private equity, infrastructure, growth, VC and private credit. We have the mandate and capabilities to support our clients with bespoke financing solutions across different fund sizes, geographies, as well as in various stages of fund life-cycles. In addition to subscription line financings, we can on a selective basis provide NAV/Hybrid financings, SMA financings, GP/Management financings and fund-backed HoldCo/SPV financings. As we form part of Nordea's well established Leveraged Finance team, we commonly partner with our leveraged finance colleagues to provide flexible and tailor-made financing solutions across OpCo, HoldCo and fund level. We apply a deep and fundamental relationship-driven approach towards our clients and aim to establish ourselves as the #1 partner bank for global fund finance and Leveraged Finance business with a Nordic nexus.



OAKNORTH BANK

Launched in September 2015, OakNorth Bank provides fast, flexible debt finance (loans of £250k up to tens of millions of pounds) and has lent over £10B to date. Its experienced fund specialists have built a strong track record of supporting investment firms, private equity companies, and funds, providing bespoke debt finance solutions, including NAV financing, liquidity lines, capital call facilities, umbrella loan-on-loan facilities and more. Its expert lending teams have worked across a host of industry sectors, and have the in-house capabilities to understand each funds' strategy – from asset level to fund level – offering the full spectrum of fund finance facilities within one team.



PINSENT MASONS

Pinsent Masons is a multinational law firm with a reputation for delivering high-quality legal advice rooted in its deep understanding of the sectors and geographies in which our clients operate. With over 2,000 lawyers operating from 28 locations throughout Europe, Asia Pacific, the Middle East and Africa, Pinsent Mason is well-placed to advise on complex multi-jurisdictional matters across a full range of legal disciplines.

The firm has significant international credentials in the global energy, infrastructure, financial services, real estate and advanced manufacturing and technology sectors. When it comes to the fund finance industry, Pinsent Masons' experts are involved in a wide range of transactions, including subscription facilities, NAV facilities, hybrid facilities, and GP and management fee facilities.

SEWARD & KISSEL LLP

Seward & Kissel, founded in 1890, is a leading U.S. law firm with an international reputation for excellence. We have offices in New York City and Washington, D.C.

Our practice primarily focuses on corporate and litigation work for clients seeking legal expertise in the financial services, corporate finance and capital markets areas. The Firm is particularly well known for its representation of major commercial banks, investment banking firms, investment advisers and related investment funds (including mutual, hedge and private equity funds), broker-dealers, institutional investors and transportation companies (particularly in the shipping area).

The Firm's attorneys are very experienced and highly regarded in their respective practice areas. Many have been with the Firm for most, if not all, of their legal careers. Our focus and expertise, combined with the Firm's stability, have enabled us to create a work culture that is dedicated to professional excellence and sound judgment, and that is committed to providing our clients with effective, high quality, hands-on legal service.



STEPHENSON HARWOOD LLP

Stephenson Harwood is a law firm with over 1100 people worldwide, including more than 180 partners. Our people are committed to achieving the goals of our clients - listed and private companies, institutions and individuals. Our work with banks and financial institutions is central to our practice. When Stephenson Harwood was founded in 1875 one of our first clients was the Hong Kong and Shanghai Banking Corporation. This relationship still holds true today. Although our firm and finance practice has grown substantially from our beginnings our work with financial institutions remains a key focus of the firm. We regularly advise funds, leading banks (including investment, central, development, clearing, retail, EXIM and boutique banks), asset and wealth managers, intermediaries and pensions providers advising on the full range of financial, commercial, corporate and regulatory matters.



WALKERS

Walkers' global fund finance group comprises dedicated fund formation and finance lawyers who act on complex and innovative fund financing solutions and advise clients across the world's financial markets. As one of the first offshore teams to work on subscription line credit transactions and hedge fund financing platforms, for both lender and borrower clients, we provide an unmatched depth of expertise across our global network in the Americas, EMEA and Asia. In a volatile world we are a safe pair of hands in safe jurisdictions.

Our fund financing teams have been at the forefront of the development of the fund finance market in these regions, working closely with leading financial institutions, investment managers and law firms. Our people and our approach to solving our clients challenges are tried and tested, but that doesn't mean we ever stand still.

Walkers' global fund finance group provides commercially focused advice to both lenders and borrowers on a range of financing solutions. Our multi-disciplinary team has an in-depth understanding of the structures used by investment managers and the legal and commercial issues relevant to fund finance providers. Our clients include agents, banks, alternative lenders and investment fund managers, including private equity, credit, real estate and hedge funds. Markets change, regulation evolves, businesses adapt, and we keep on reinventing our service for the times we find ourselves in.

MEDIA SPONSORS



GLOBAL LEGAL GROUP

Global Legal Group is an independent digital media company based in central London. Our clients are private practice and in-house lawyers, multinational corporations, and professional services firms in over 190 countries around the world.

In 2011, GLG introduced Global Legal Insights, an essential analytical resource detailing current legal issues spanning 16 practice areas. Global Legal Insights to Fund Finance was launched in 2017. Affectionately known in the fund finance community as The Pink Book, it is now in its seventh edition, providing in-depth analysis of market conditions, regulations and laws, covering 19 key jurisdictions, with 27 expert analysis chapters providing comprehensive insight and up-to-date analysis.

Our mission is to provide outstanding performance for our clients and partners. We provide the digital technologies and expertise that they need to boost their brand exposure and market reach, as well as access to the world's leading online network of legal experts. By only partnering with the leading legal and business authorities, we also ensure that the information we provide is topical, enlightening and authoritative, making our products the go-to resource.



PEI MEDIA

PEI is the specialist information group that focuses only on alternative asset classes. These have become essential components of institutional investors' allocation strategies globally and we major in private equity, real estate, private debt and infrastructure whilst also engaging with emerging new asset classes too.



PREQIN

Preqin is the Home of Alternatives®, the foremost provider of data, analytics and insights to the alternative assets community. From pioneering rigorous methods of data collection to developing a revolutionary platform, we have committed ourselves to furthering the understanding of alternatives for over 18 years. Through close partnership with our clients, our 300 researchers based in key financial centers worldwide combine with cutting-edge technology to make sure our data and research is unique, timely, accurate and insightful.

Today, over 120,000 fund managers, investors, placement agents, service providers, advisors and other industry professionals from more than 38,000 firms worldwide are empowered with information that underpins their daily workflow including fundraising, asset allocation, investor relations, origination and business development.

- Private Equity & Venture Capital • Private Debt • Hedge Funds
- Real Estate • Infrastructure • Natural Resources

Preqin is an independent business with staff based in London, Dubai, Frankfurt, New York Chicago, Singapore, San Francisco, Sydney, Tokyo, Hong Kong, Guangzhou, Bangalore and Manila.



THE DRAWDOWN

The Drawdown provides vital insight and analysis for operational professionals in private equity and venture capital.

Our mission is to empower and celebrate operational professionals.

Operational professionals ensure funds are managed in a robust and compliant manner, thereby protecting investors and the wider economy. More than that, operational professionals lead on in-house technology strategies, regulations and compliance, fund structuring, ESG, cyber security and many more vital functions that ensure the well-being of the industry. It is against this backdrop that The Drawdown strives to shine a light on this vital work done.

MEET OUR SPEAKERS



SUKHVIR BASRAN

Cadwalader, Wickersham & Taft

Sukhvir Basran is a partner in Cadwalader's Financial Services and ESG Groups. Combining her substantial experience as a banking and finance lawyer, Sukhvir advises and works with financial institutions on incorporating innovative financing and impact investment structures anchored in rigorous impact outcomes into mainstream transactions. She advises clients on ESG strategies, policies, disclosure and reporting, ESG-related transactions and products as well as integration of ESG into investment processes and systems. Sukhvir plays an active role in developing the sustainable finance sector through the creation of strong partnerships and collaborations. Her work extends beyond purely legal including enabling her clients to engage with their customers and clients to create sustainable investment business models. Sukhvir believes that legal advice needs to be provided in the context of the wider ESG landscape, mainstream and impact investing, and she works closely with trade associations and industry bodies, standard setters, and data providers to deliver an end-to-end service for clients. She is involved with several organizations and financial institutions in the Gender Lens and diversity investing space to develop products and deepen engagement to promote gender equality outcomes. She is a member of the LMA's ESG committee, is Independent Chair of the 2X Global's inaugural board, is on the Steering Committee of GenderSmart JEDI, is a member of the Global Alliance of Impact Lawyers' Board and is working on a UN-led Taskforce on the creation of an ESG Board Certification. Sukhvir also launched "Aurora: The Gender Lens Project" with the 2X Collaborative and GenderSmart.



AHLEM BEN GUEBLIA

ANZ

Ahlem Ben Gueblia is the Head of Financial Sponsors Europe at ANZ. Her team is responsible for the coverage of Financial Sponsors clients and focuses on the origination and structuring of liquidity solutions including fund finance facilities as well as FX and interest rate hedging.

Prior to joining ANZ in 2022, Ahlem spent 17 years at Credit Agricole CIB with the last 7 years as an Executive Director in the Private Equity Funds Solution team.

She holds a Master's degree in Economics from the University of Paris 1 Pantheon-Sorbonne.



NAVDEEP BENNING

Ashurst LLP

Navdeep Benning is a Fund Finance partner in the Ashurst Global Loans Team. Based in London, she has also spent time working in Ashurst Hong Kong and Ashurst New York.

Navdeep has been a Fund Finance lawyer since the inception of the market and, with over 16 years' experience, is a recognised expert in her field. She acts for lenders and borrowers on all aspects of Fund Financings, including capital call, NAV & asset backed facilities, single-investor facilities, letter of credit facilities, GP & co-investment facilities, hybrid facilities and equity-commitment-backed financings.

In what is a rapidly expanding and vastly competitive market constantly looking for the next growth opportunity, Navdeep's range and breadth of experience ensures she is always ahead of the curve. With a particular focus on the growing areas of NAV, leveraged and asset backed facilities, she specialises in putting in place bespoke finance solutions.



RICHARD BRAHAM

Commonwealth Bank of Australia (CBA)

- 20+ years of experience in Institutional Banking, having now been with CBA for over 6 years.
 - Currently Head of NBF Europe, covering our international Funds, Sponsor and Insurance clients
 - Formerly Deputy Head of Insurance client coverage at Barclays Corporate
 - Richard also holds a degree in Business Commerce from the University of Birmingham
-



GREG BROWN

Allen & Overy LLP

Greg is a partner in A&O's finance department and has expertise covering a wide range of debt financing practice areas, including fund finance, corporate lending, trade and commodities finance and acquisition finance for public and private bids.

Greg is also the head of Allen & Overy's Social Finance and Impact Investment Group.

Greg has been involved in structuring sustainable and other impact investments for over a decade, acting both for borrowers and funders in that sector. In recent years, Greg has been heavily involved in market developments concerning green and sustainability-linked loan financings, which have now become a well-established and increasingly standard feature in the syndicated loan market.



KATHRYN CECIL

Fried Frank

Kathryn Cecil acts for funds, lenders, borrowers, and sponsors on a range of complex domestic and cross-border finance transactions focusing on fund finance and leveraged finance.

In the fund finance space, Kathryn advises on subscription, asset-backed, NAV, GP solutions and other structured fund financings.

The Legal 500 UK recognizes Kathryn in Acquisition Finance, Bank Lending and Fund Finance where she wins praise from a client as having "excellent knowledge of the fund financing market." Chambers UK recognizes Kathryn in the Banking and Finance: Fund Finance category and quotes "Kathryn is an exceptional lawyer and leading practitioner in fund finance. Her legal strengths are matched by her commercial acumen, and she delivers in spades on every deal."

Kathryn is listed in The Drawdown's list of the Most Influential Fund Finance Experts. The report showcases individuals who have shaped the market, and whose achievements have had a major influence on the fund finance sphere.

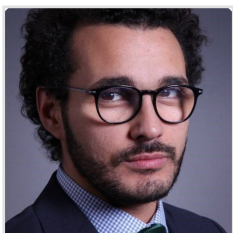

MABROUK CHETOUANE

Natixis

PhD. in economics from the University of Paris-Dauphine (thesis defended in 2010) and master's degrees in statistical modeling from ENSAE (École Nationale de Statistiques et d'Administration Economique) and in macroeconomic modeling (University of Paris Panthéon-Sorbonne), Mabrouk was previously head of research and strategy at BFT-IM (a subsidiary of the Amundi group). He was a senior economist at IHS-Markit and an econometrician at the Banque de France, where he was in charge of inflation forecasts for the Eurosystem's forecasting exercises. He is also a lecturer in time series econometrics at the University of Paris Dauphine and at the Ecole Centrale de Paris.



PARISA CLOVIS

Kirkland & Ellis LLP

Parisa Clovis is a debt finance partner in the London office of Kirkland & Ellis International LLP.

Parisa's experience focuses on funds finance acting for borrowers and sponsors (both domestic and international) in connection with NAV and hybrid facilities, subscription line facilities, GP support lines and refinancings across a range of sectors and asset classes. Parisa also has substantial experience in advising lenders in respect of funds finance transactions with the addition of undertaking a six-month secondment with a French bank.



JULIA CORNETT

Maples Group

Julia is a partner of Maples and Calder's Finance team in the Maples Group's London office. Julia has extensive experience in corporate finance, fund finance and structured finance transactions and advises on all aspects of banking, securitisation, repackagings, fund and other finance matters. She represents both borrowers and large bank syndicates, as well as hedge funds and private equity funds, on lending and financing transactions.

Julia advises on a wide range of corporate and commercial deals, including restructurings, joint ventures and M&A transactions as well as on all aspects of establishing and maintaining corporate entities, limited partnerships and segregated portfolio companies. She also has significant experience in debt listings on the Cayman Islands Stock Exchange.

Julia joined the Maples Group in 2012. She previously worked for an international law firm in London and, before that, for Torys LLP in Toronto, Canada.



ALDO DI RIENZO

Rothschild & Co

Aldo is the Chief Financial Officer of the Merchant Banking division at Rothschild & Co where he is responsible for the divisional Finance function, the operations of the corporate private equity funds and for the evolution of the division's IT capabilities.

Prior to joining the firm in 2017, Aldo held different Finance and Operations roles at Credit Suisse, UBS and Banca Esperia (Mediobanca Group) in the UK, Switzerland and Italy. Before working in financial services, Aldo developed his career in Telecom and Consumer Goods, gaining exposure to the different business dynamics of these industries.

Aldo is a Business Management graduate from Bocconi University in Milan and holds a Master of Science Degree in Accounting from Babson College in Boston.



GIOVANNI DI STEFANO

Nomura

Giovanni is a Managing Director and EMEA Head of Fund Level Hedging in Nomura. He has extensive experience in supporting clients around their FX and Interest Rate risk management activities. During the past 15 years, Giovanni has assisted global financial sponsor clients on derivative needs for event driven transactions, fund level and portfolio exposures.

Product expertise includes: FX cash, vanilla and exotics options with focus on Deal Contingent, Interest Rate swaps and options including cross-currencies



FAATWIMA DILJORE

AlbaCore Capital Group

Faatwima Diljore has over 15 years' experience across investment banking and credit markets. As Head of ESG and Fund Financing at AlbaCore Capital, she leads leverage financing, manages relationships with the banking community and drives the firm's ESG efforts. Prior to joining AlbaCore Capital, she was a Director at Citi where she focused on managing and restructuring debt for corporates, banks and sovereign issuers across Europe, Middle East and Africa.

Ms. Diljore is a member of AlbaCore's Investment Committee and ELFA's ESG Committee. She holds a MSc in Applied Statistics from the University of Oxford and a BSc in Economics and Statistics (First Class Honours) from University College London. She is also a CFA® charterholder.



MICHAEL DURNIN

Ares Management

Mr. Durnin is a Principal in the Ares Secondaries Group, where he focuses on capital markets activity. Prior to joining Ares in 2022, Mr. Durnin was a Vice President at Goldman Sachs Asset Management, where he was responsible for fund financing activity across the division, with a primary focus on the fund-of-funds platform. Previously, Mr. Durnin was an Associate General Counsel at BasePoint Capital, LLC, a boutique specialty finance lender, where he was involved in a broad array of functions across the firm. He holds a B.B.M. from Stony Brook University in Finance and a J.D. from New York Law School.



RUSSELL EVANS

National Australia Bank Limited

Russell heads the team responsible for financial sponsor client coverage in Europe. This includes responsibility for structuring and delivering liquidity and risk management solutions for private capital sponsors including subscription finance, NAV and hybrid facilities, as well as FX and interest rate hedging for open and closed-end funds. Russell has over 15 years of experience in delivering all aspects of fund financing, including the structuring and implementation of complex bilateral and syndicated debt facilities, capital markets solutions, sustainability linked loans, structured deposits and portfolio risk management solutions. Prior to joining National Australia Bank in 2010 he spent 10 years at Lloyds Bank covering Financial Institution clients including financial sponsors in both the private equity and real estate sectors. His earlier career was focused on project financing infrastructure and natural resources projects. He holds a Master of Science degree from the University of Leicester and a Bachelor of Science degree from the University of Southampton.



GREG FAYVILEVICH

Fitch Ratings

Greg Fayvilevich is a Senior Director and head of Fitch Ratings' Funds & Asset Managers group, based in London. The Funds group is responsible for Fitch's coverage of money market funds, local government investment pools, and bond funds. Greg's team is responsible for assigning and maintaining ratings, developing rating criteria and models, and publishing research on analytical and regulatory developments affecting the sectors the group covers.

Previously, Greg was a member of the Financial Guarantors group at Fitch. Prior to joining Fitch, Greg worked for ACE Group.

Greg earned a BS in finance from Rutgers University.



RICHARD FLETCHER

Macfarlanes

Richard advises financial institutions, investment managers and other market participants on a wide range of fund finance transactions.

His practice includes advising on:

- subscription and capital call facilities;
- NAV facilities;
- credit fund leverage and repo facilities;
- GP and co-investment facilities; and
- management company facilities.



NICOLA GERMANO

[Intesa Sanpaolo IMI Corporate & Investment Banking Division](#)

Nicola joined Intesa Sanpaolo in 2015 and became responsible for the origination, structuring and execution of fund financing deals (Subscription financing, NAV financing, GP financing, Hybrids) within the Financial Sponsor Group. He's now leading the Fund Financing team and he is based at the firm's head office in Milan.

Before joining Intesa Sanpaolo, Nicola spent seven years at Goldman Sachs in London where he was a sales/trader in equity financing within the prime brokerage arm of the firm. He started his career at BNP Paribas in Milan in 2001 and worked there for five years within the relationship management team.

Nicola holds a Bachelor Degree in Economics at University of Florence.



MATT GLEN

[Lloyds Bank](#)

Matt Glen is a Director at Lloyds Bank. Based in London, he is part of the Financial Sponsors team, which is a leading global private markets fund finance franchise. The business sits within the wider Institutional Coverage group and is responsible for the origination, structuring, execution and management of investor recourse and asset backed fund finance loans and comprehensive relationship coverage.

Matt has worked in industry since 2014 and has broad experience originating and executing fund finance transactions across the private markets asset classes, with deep structuring expertise across NAV, hybrid and investor-recourse backed facilities. Matt's role at Lloyds is focused on the origination of structured lending opportunities for the Financial Sponsors business, and on strategic partnerships to support the continued growth of the franchise.

During his career, Matt has worked across other banking disciplines, including overseas in New York and Sydney. Prior to joining Lloyds, Matt was a Director in ING's Fund Finance team.



ALEX GRIFFITHS

[MUFG Investor Services](#)

Alex Griffiths is the Head of Structuring in the fund finance team at MUFG Investor Services. He and his team are responsible for building the business out across the globe and his role comprises originating, structuring, executing and covering deals across the book, primarily focusing on Europe but also APAC and the US. Alex has over 15 years of industry experience.



HELEN GRIFFITHS

[Investec](#)

Helen is the Head of Structuring for Investec's fund solutions business. Her role focuses on designing solutions and developing relationships with funds and fund managers across different strategies throughout the lifecycle of the fund. Helen works closely with the team's distribution and fund raising platforms for capital call, GP/co-invest and NAV financing. Helen has been connected to the fund finance industry for 15 years.



ANDREW HUSDAN

Clifford Chance LLP

Ranked by both Legal 500 and Chambers, Andrew is the co-head of the Clifford Chance fund finance practice and has a first class reputation in the area of funds finance, acting for both sponsors and lenders for over 10 years, and having advised, in the financial year ending 2023, on over EUR15 billion (equivalent) of fund finance facilities.

As well as traditional capital call and bridge financings, Andrew also leads on more innovative and complex structured financings. These involve hybrid financings, NAV lending (across different asset classes, including real estate, private equity, direct lending, secondaries), preferred equity structures (including back-levered prefs) and non-bank financings (involving both loans made by non-bank lenders to funds, as well as fund-raising structures used to originate non-bank capital, in particular in the insurance and pension company space.)

Andrew is also sought out by participants in the market (who are considering becoming lenders in relation to existing financings) in order to obtain his views (e.g. via red-flag reviews and enforcement memo analysis) on the transaction structure and documentary package of the existing financing. In effect, this means that even where Andrew/Clifford Chance are not lead counsel on a transaction, they are still getting exposure to a range of documentation and facilities via such 'review instructions'.

Andrew is a regular speaker at Fund Finance Association conferences, and has led various training initiatives and talks, including as part of the FFA University programme.



SABIH HUSSAIN

Barings



JAMES KINSLEY

Carey Olsen

James has extensive experience of debt finance transactions in Europe, Asia and the Middle East. He advises on all aspects of private debt (including special situations), structured finance, leveraged finance, acquisition finance, take-private transactions, bond issuances, convertible instruments, derivatives (from synthetic CLOs to pre-IPO financings and strategic equity financings), property finance and syndicated lending. In addition, James regularly acts on fund finance transactions (for both lenders and borrowers, including subscription financings, NAV and hybrid facilities), as well as securitisations, CLOs and private debt funds. James also advises on a wide range of general corporate and commercial matters, including restructurings, joint ventures and private M&A transactions.

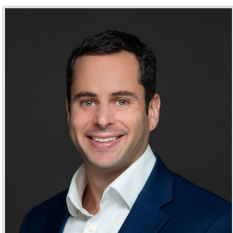

DAVID LAZAR

Allvue Systems

David is a Senior Director - Portfolio Manager and Head of Product Delivery Architecture at Allvue. David previously played a leadership role on the Professional Services team at Allvue, which included overseeing the Portfolio Compliance Implementations team. Prior to joining the company, he worked at Eze Software Group. David is a CFA Charterholder and holds Master of Arts and Bachelor of Arts degrees in Economics from the University of California, Los Angeles.



MATT LILLEY

Mayer Brown LLP

Matt Lilley is counsel in the Banking & Finance practice of the London office. He has extensive experience acting for lenders, sponsors, funds and borrowers on lending transactions in the infrastructure and funds finance sectors. Matt's funds finance experience covers many asset classes and fund structures (including private equity funds, credit funds, infrastructure funds, secondary funds, real estate funds, emerging market funds) and he has advised on a wide range of transactions covering subscription facilities, NAV/asset back facilities, hybrid facilities and co-investment facilities). His practice also includes corporate infrastructure financing (both acquisition financing and refinancings), acting for both lenders and sponsors/borrowers on a variety of funding structures, including traditional bank financings, institutional funding arrangements and private placement issuances, and establishment of common terms platforms.



GIANLUCA LORENZON

Validus

Gianluca is a seasoned financial services professional with over 25 years of experience. In his most recent role as head of European origination for Hark Capital, the pioneering New York-based concentrated NAV lender (formerly owned by abrdn), he led the origination efforts for the European market.

Gianluca began his career at JPMorgan and later worked at KPMG Corporate Finance, specializing in mid-market M&A transactions for financial sponsors and corporates, both public and private, for approximately a decade. He then joined the Bank of Ireland's Leveraged Acquisition Finance team in late 2007, where he supported mid-market and upper mid-market European buyouts in both club and underwritten deals for sponsors such as HgCapital, PAI, Investcorp, Montagu, Equistone, and Providence.

Having then joined Standard Life Investments, the precursor company to the current abrdn he worked in direct lending, high yield and multi asset private credit before joining Hark Capital. At Hark Capital, Gianluca worked with several asset classes, ranging from Buyouts to Real Estate, from VC technology to structured credit.

Gianluca holds a BSc (Econ) Analytical and Descriptive from the London School of Economics and Political Sciences and an MSc Economics & Finance from University of Bristol.



STEVEN MANSY

Macquarie Group

Steven Mansy, Head of Fund Finance Origination EMEA

Steven Mansy leads Macquarie Group's Fund Finance origination function across EMEA, partnering with GPs and their limited partners to provide bespoke capital call and NAV financing solutions throughout the fund lifecycle, secured against uncalled LP commitments or underlying portfolio interests.



PIERRE MAUGÜÉ

Debevoise & Plimpton

Pierre Maugüé is a finance partner in the London office of Debevoise & Plimpton.

Mr. Maugüé is recommended by The Legal 500 UK. The guide has described him as "exceptional," "responsive, commercial and creative," "technically very strong" and a trusted adviser who helps clients achieve goals in the most efficient manner. Mr. Maugüé is also recommended as a leading lawyer by IFLR1000 (2022).

Mr. Maugüé brings a global perspective to his work, having lived and worked in Asia, Europe and the United States. He joined Debevoise in 1999 in the firm's Hong Kong office. He relocated to the New York office in 2002 before moving to London in 2014.

Mr. Maugüé writes frequently on legal matters related to finance topics and is also a regular contributor to the Debevoise & Plimpton Private Equity Report.

Mr. Maugüé received a Magistère and DESS in Business and Tax Law, with high honours, from the University of Paris II-ASSAS in 1991, and a Master of Laws in Comparative Jurisprudence from New York University in 1995.

Mr. Maugüé was admitted to the New York Bar in 1996 and as a solicitor in England & Wales in 2016.



PHILIPPE MAX

Dentons

Philippe Max is a finance partner in Dentons' Paris office. He works on domestic and international banking and finance transactions. He is specialised in fund finance, advising banks, financial institutions, custodians, managers and general partners on a wide range of fund finance transactions. He also advises clients on a large scale of structured finance and cross-border transactions.



KEENAN MCBRIDE

Morgan Stanley

Keenan McBride is an Executive Director in Fixed Income Secured Lending at Morgan Stanley. Mr. McBride currently handles the origination, structuring, and distribution of subscription secured credit facilities for private equity funds globally, and has been covering the product exclusively for ten-plus years. His clients include top tier alternative asset managers headquartered in North America, Europe, and Asia. Prior to joining Morgan Stanley, Mr. McBride worked in the subscription finance group at Sumitomo Mitsui Banking Corporation and on the leveraged finance syndications team at RBC Capital Markets. Mr. McBride graduated from Boston College.



JAMIE MEHMOOD

Dentons

Jamie is Head of the Fund Finance Advisory business within the 100+ strong Debt & Capital Advisory team at Deloitte. The Fund Finance Advisory team has been in operation since 2020 and has grown over that time to a headcount of five experienced Fund Finance professionals, all of whom look solely at Fund Finance (currently recruiting for a sixth). In this role, Jamie is involved in a range of financings across the full breadth of the Fund Finance market (by product, sector and size), covering everything from first time debt raises to multi-billion dollar syndicated subscription line financings and structured PE NAV transactions.

Prior to joining Deloitte in January 2020, Jamie worked at RBS for 19 years in a range of roles around Fund Finance, covering debt structuring and execution as well as latterly a role as co-head of the Funds Banking relationship coverage team. During his time at RBS Jamie also spent six months working on secondment at a leading private debt fund and for three years was responsible for developing RBS plc corporate bank's strategy for the provision of finance to support Sustainable Energy.

Jamie is qualified as a Chartered Accountant, having studied Geography at Magdalene College, Cambridge.



ROXANA MIRICA

Apax

Roxana Mirica joined Apax in 2017 as head of Capital Markets in Europe. She is responsible for leading acquisition financing and ongoing debt and equity capital markets transactions for Apax's portfolio companies, as well as fund level financing. Additionally, Roxana manages day-to-day relationships with banks and institutional debt and equity investors. Roxana also serves on the boards of Genius Sports and the Apax Foundation.

Prior to joining Apax Partners, Roxana spent 9 years at Barclays, most recently as Director in Leveraged Finance.

Roxana holds a BA in Economics and Chemistry cum laude from Dartmouth College.



SHELLEY MORRISON

abrnd

Shelley Morrison is Head of Fund Financing at abrnd with extensive experience in the origination, structuring and execution of fund level debt facilities. She has been with the company since 2019. Before joining the company, Shelley was a Relationship Director in the Fund Finance team at RBS for 6 years where she managed a portfolio of subscription loans, NAV loans and GP finance to global funds across Private Equity, Private Debt, Infrastructure and Real Estate. Prior to that, she worked in structured asset finance at RBS and Lloyds for 10 years, with a focus on commercial ship finance. Shelley received a first-class honours degree in Geography and an MSc in Social and Political Theory, both from the University of Edinburgh.



ALEX MURRAY

Preqin

Alex Murray is a built environment economist specialising in private financing of public infrastructure. Starting his career in KPMG, Corporate Finance, his research of operational infrastructure led to his PhD in whole life cost and value. As a researcher and lecturer at UCL's Bartlett School of Sustainable Construction, he produced the analysis for a 2013 government commission on supply chains finance in construction, published with the 2013 UK Government construction strategy. He was later a Senior Analyst at the Infrastructure and Projects Authority. Alex joined Preqin as Vice President in September 2020, where he specialises in coverage of unlisted infrastructure.



JAD NADER

Ogier

Jad's core practice is in handling cross-border lending transactions, advising on fund finance, acquisition finance, debt capital markets and debt restructuring. He has particular expertise in sophisticated international financing techniques and regularly acts for major international financial institutions and private equity houses. He has also assisted on multiple regulated M&A transactions involving banks and insurance companies.

Prior to joining Ogier, Jad worked for several other high profile law firms, including a magic circle firm, and a major European bank. He has more than 16 years' experience working on Luxembourg matters and also worked for several years as head of the Luxembourg desk of a European law firm in New York.

Jad is also active in academic circles and has lectured on guarantees, mortgages, security interests, property and fiduciary rights, Islamic finance, as well as privacy and IT law.

He regularly speaks and frequently publishes on subjects such as fund finance, cross-border lending, financial collateral, BRRD and banking regulations, securities law and restructuring and corporate recovery law. He sits on the editorial board of the *Revue de Droit du Financement de l'Economie* published by Legitech. He is an active member of numerous Luxembourg and international professional associations, including the American Chamber of Commerce in Luxembourg (Amcham), the Luxembourg Association of Banking Lawyers (ALJB), the International Bar Association (IBA), the American Bar Association (ABA) and the New York Bar Association. Jad holds postgraduate degrees in private international law (DEA) and IT law (DESS) as well as a doctor of laws. His PhD thesis was on the taking of security over financial assets.



RICHARD PUGH

Dechert LLP

Richard Pugh, a partner in Dechert's global finance practice, focuses his practice on UK and European commercial real estate finance and securitization. Mr. Pugh has significant experience advising on commercial real estate lending, commercial mortgage-backed securitizations, term asset-backed securitizations (including residential, auto and credit card), securitized lending, fund and subscription finance, structured repacks and collateralized loan obligations. As a former director and assistant general counsel at Bank of America, Mr. Pugh leverages his deep understanding and knowledge of the real estate finance and securitization industry to represent clients in their most complex matters.

Mr. Pugh's also maintains an active pro bono practice, working on and supervising a number of matters through Trust Law and Kids in Need of Defense (KIND).

Mr. Pugh is recognized for Property Finance and Securitisation by The Legal 500, UK 2023 with clients mentioning his "extensive experience in EMEA securitisation, CMBS and commercial real estate finance matters."



STEPHEN QUINN

17 Capital

Stephen is Co-Head of 17Capital's credit offering and a member of the Investment Committee at 17Capital, the go-to global source of strategic finance for investors in private equity. Stephen joined the firm in 2019 from Lloyds Banking Group, where he was the Global Head of Financial Sponsors with responsibility for one of the largest fund finance businesses globally. Stephen has worked with private equity managers for almost 20 years and co-authored 17Capital's report on NAV Lending and the emerging opportunity for private debt investors.



THOMAS RAPP

Wells Fargo EMEA Investment, Financing & Solutions Group

Thomas Rapp is the Head of the EMEA Fund Finance Group within the Corporate & Investment Bank's Financial Institutions vertical.

Before joining Wells Fargo in 2012, Thomas worked at WestLB for 18 years, across London building out the Fund Finance team, New York acting as the Senior Credit officer for WestLB's Leveraged Finance and Media/Entertainment group, as well as Germany where he held various positions.

Thomas holds a Diplom Kaufmann degree in Finance and Economics from the University of Kiel (Germany).



OLIVIER RENAULT

Pemberton

Head of Risk Sharing Strategy – Pemberton Capital Advisors

Olivier is a Portfolio Manager and Head of the Risk Sharing Strategy at Pemberton, which invests in first-loss or mezzanine tranches of bank loan portfolios (large corporates, SMEs and other core assets) and provides investors access to pools of untraded loans in a diversified format.

Prior to joining Pemberton in 2021, Olivier was Managing Director and Global Co-Head of FIG Solutions at Citigroup and was a leading originator and arranger of bank regulatory capital relief transactions. Olivier started his career at S&P Risk Solutions and also worked for Stormharbour Securities as Head of Structuring & Advisory.

Olivier has 20 years of experience in structured credit, securitisation and bank capital finance. Olivier has an MSc in Finance from Warwick University (UK), a PhD in Economics from Université Catholique de Louvain (Belgium) and was also a Finance Lecturer at London School of Economics and Political Science (UK).



ANDY ROBERTS

RBS International

Andy is a Senior Director at RBS International specialising in Fund Finance. He has spent the last 15 years in a number of roles including Relationship Management, Portfolio Management, Deal Structuring and Execution across a range of Funds and FI asset classes.

Andy is part of the RBS International London leadership team, and he currently leads the Private Debt strategy offering. The team provide a range of solutions ranging from traditional banking services through to bespoke financing solutions for funds and fund managers.



CAMERON A. ROPER

Proskauer

Cameron Roper is a partner in Proskauer's Corporate Department and a member of the Finance Group (working closely with the Firm's Private Funds Group). Cameron specializes in funds finance and general lending and advisory work, acting for both fund managers and financial institutions. He regularly advises on net asset value (NAV) facilities, hybrid facilities and subscription line facilities, as well as general partner commitment, manager, carry and co-investment facilities. His experience covers a wide range of funds, including credit, large buyout and mid-market funds, venture, secondaries, infrastructure, real estate, fund of funds and emerging market funds.



EMMA RUSSELL

Haynes Boone

Emma Russell is a partner and head of the Finance Practice Group in the London office of Haynes and Boone. Emma is an experienced loan finance lawyer with extensive knowledge in global fund finance, real estate finance transactions, and structured and specialty finance, as well as more general experience in acquisition, leverage, and general corporate finance. Her practice focuses on the full range of fund lending products across all fund sectors, (including private equity, real estate, secondaries, infrastructure, and hedge) from capital call facilities, hybrid/NAV facilities, to general partner support, co-invest facilities and portfolio acquisition facilities and assisting funds with structuring. Emma has significant experience advising credit funds and their lenders in relation to leverage facilities to CLO's/CDO's and securitisation vehicles. Emma's experience also includes advising both lenders and funds on private equity, receivables financing, asset based lending, speciality finance, real estate fund structuring, and acting for both lenders and sponsors in relation to investment and development real estate finance and leverage restructurings. Emma has spent significant time working in-house with various financial institutions during her career. She has gained varied experiences with both business and legal teams across all lending sectors. Emma co-chairs the European Committee of Women in Fund Finance, a group associated with the Fund Finance Association, which is focused on recognition and promotion of women leaders within the alternative investment fund finance industry.



JOHN SAYERS

Simmons & Simmons LLP

John Sayers is a Partner in Simmons & Simmons International Funds Finance team. He advises lenders and borrowers on a NAV, hybrid and capital call facility structures involving a wide range of jurisdictions, fund structures and asset collateral classes. John is also experienced in repackaging and balance sheet management solutions for lenders.



MICHAEL SCHAD

Coller Capital

As Head of Coller Credit Secondaries, Michael is responsible for the growth and development of Coller Credit Secondaries, beyond his day-to-day origination activity. He is based in the firm's London office.

Prior to joining Coller Capital in 2005, Michael worked in the investment banking divisions of Deutsche Bank and Credit Suisse First Boston in London.

Michael has a BA (Hons) in International Business Studies from the European Business School, London and an MSc in Finance from the London Business School.



PRAMIT SHETH

KBRA

Pramit Sheth is a Senior Managing Director at Kroll Bond Rating Agency, where he manages the Funds group. Pramit has over 15 years of experience in credit ratings. Before moving over to the Funds Group, Pramit was a senior member of the KBRA CMBS team, where he helped develop various methodologies and was part of the analytical credit team.

Before joining KBRA, Pramit was an associate at S&P within the CMBS Group. Prior to that role, he was the founder of a real estate development and construction company. Pramit began his career as an analyst associate at S&P Global Ratings, where he worked on CMBS and ratings and research.

Pramit holds a B.S. in finance and information systems with a minor in mathematics from the New York University Stern School of Business.



KATE SINCLAIR

[Simpson Thacher & Bartlett LLP](#)

Kate Sinclair is a Partner at Simpson Thacher & Bartlett LLP, where she is co-head of the London Fund Finance Practice and a member of the Banking and Credit Practice. Kate has extensive experience in advising private equity and other investment funds on complex financings designed to provide fund-level leverage to facilitate and support investment activities. She regularly advises leading sponsors on a broad range of financings including capital call facilities, NAV facilities, GP facilities and co-investment facilities as well as other bespoke financing solutions.

Kate is recognised as a “Notable Practitioner” by IFLR 1000 and was recently named one of The Drawdown’s “Most Influential Fund Finance Experts of 2022”. She has also spoken at Fund Finance Association conferences and is actively involved in Women in Fund Finance, an organisation focussed on the increased engagement and promotion of women leaders within the fund finance industry.



SLADE SPALDING

[NLC Capital Partners LLP](#)



LEON STEPHENSON

[Reed Smith](#)

Leon is co-head of the Reed Smith fund finance team, based in London. Leon and the team work with banks, other financial institutional lenders, managers, general partners and limited partners of funds on specialist fund financing transactions with private equity, secondaries, real estate, direct lending and infrastructure funds.

Leon has particular specialist knowledge of NAV/asset-backed and hybrid facilities, secondary funds facilities, capital call facilities, co-investment and GP/manager support facilities and other types of liquidity facilities provided to funds.

Leon is recognized as a “Leading Individual” in Fund Finance by Legal 500 UK 2022 and the team is recognized in Band 1 in Fund Finance by Legal 500 UK 2022. Leon was also recognized as “Partner of the Year for Banking” at the Client Choice Awards 2017. Leon represents a large proportion of lenders that provide fund financing as well as a number of private equity and other funds on complex fund finance transactions.



VICTORIA STEWART

[Partners Group](#)

Victoria Stewart is the Global Head Fund Financing sitting within the Capital Markets business unit at Partners Group. She has been with Partners Group since 2011 and has 20 years of industry experience, primarily in sourcing, structuring and executing fund level and equity bridge facilities. Prior to joining Partners Group, she worked as a lawyer in private practice in Edinburgh, UK. She holds a bachelor’s degree in law, a master’s degree in management and a postgraduate diploma in legal practice from the University of Aberdeen, UK and a master’s degree in European and international business law from the University of St. Gallen (HSG), Switzerland.



STEPHEN THOMAS

Coller Capital



STEVE TREMBLAY

Assured Guaranty

Steven Tremblay is a Managing Director in the Structured Finance Originations group of Assured Guaranty. During his 23-year tenure at Assured Guaranty and its predecessor Financial Security Assurance ("FSA"), Mr. Tremblay also served various roles in the Structured Finance portfolio management group, most recently serving as the Chief Surveillance Officer for the Structure Finance portfolio.

Previously, Mr. Tremblay served as the Head of Credit for the Financial Products business of FSA. Prior to Assured Guaranty, Mr. Tremblay worked in the Structured Finance Surveillance groups of S&P and bond insurer MBIA.

Mr. Tremblay received an MBA in Finance from Pace University and a BSc from the Department of Anatomy & Cell Biology of McGill University.



MARCO UNTI

Deutsche Bank

Marco joined DB's Global Credit Trading team in 2016 and he now runs the Structured Credit Financing business in Europe. Marco and his team offer a number of fund financing solutions spanning the product spectrum from subscription financing to NAV facilities and fund-supported single asset financing. Before joining DB Marco spent 11 years at Credit Suisse, where he held a variety of structuring and trading roles within fixed income.



OLIVIER VERMEULEN

Paul Hastings

Olivier Vermeulen is Office Chair of the Paris office of Paul Hastings and head of the Global Finance department. With a focus in banking and finance, he has extensive experience in leveraged financing (senior, second lien, mezzanine, unirate/unitranche, and SSRCF/high-yield financings), fund financing (EBF and capital call facilities), structured finance (securitization), debt negotiations, and Islamic finance.

Mr. Vermeulen advises both sponsors and borrowers (private equity and infrastructure funds as well as large corporate funds) as well as financial institutions (senior/mezzanine lenders and debt funds).

His strengths in innovation are very clearly demonstrated through the creation of a new product for the French bank finance market in the form of the equity bridge finance facility for European funds.



RAGHAV WADHAWAN

Standard Chartered Bank

Raghav Wadhawan is an Executive Director at Standard Chartered Bank. Based in London, he is part of the Sponsors Coverage team which is a global coverage team focused on origination and execution of transactions for Private Equity Funds across the fund and asset level. His focus is on covering Sponsors across Private Equity, Real Estate, Credit, and Infrastructure sectors and on a global basis. Raghav is responsible for supporting Sponsor clients with fund facilities, ranging across Subscription, Hybrid, NAV, and GP Financing. He has an Economics degree from the London School of Economics and a Masters in Finance from Imperial College. Raghav is also a CFA charterholder and part of the FFA EMEA Executive Committee.



SIMON WITNEY

Travers Smith LLP

Simon is a senior consultant who works mainly with clients active in private markets. He has particular expertise in sustainable finance and corporate governance.

Throughout his career Simon has been a prolific writer and regular speaker on company law and corporate governance and over the last 20 years or so he has advised private equity clients, as well as the UK Government, on a wide range of fund and transactional matters. He has a market-leading reputation in the private equity sector with both Real Deals magazine and Private Equity International magazine having named Simon amongst the most influential figures in private equity.

Simon has been a member of the BVCA Council, was chair of the BVCA's Legal and Accounting Committee between 2010 and 2016, and has also chaired Invest Europe's Tax, Legal and Regulatory Committee.

In addition, Simon is a Visiting Professor in Practice in the Law Department at the London School of Economics and Political Science, where he also teaches on the LLM programme. Simon's book, Corporate Governance and Responsible Investment in Private Equity, was published by Cambridge University Press in 2021.



PAUL WORSNOP

Appleby

Paul Worsnop is Counsel within the corporate department in Jersey. He has a broad practice and advises on all aspects of corporate and finance transactions with a particular emphasis on debt and equity capital markets, structured finance, funds and technology.

Prior to commencing his legal career, Paul spent two years as a project manager in the software development industry which is reflected in the commercial and practical advice he offers his clients and his sector focus.

Paul is involved with a number of industry working groups on the Island looking at areas including capital markets, the implementation and regulation of Fintech in Jersey, the AML/KYC regime and legal reform.

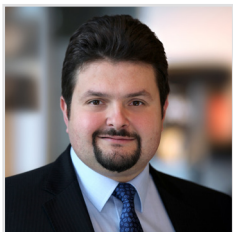

VASSILIYAN ZANEV

Loyens & Loeff

Vassiliyan Zanev co-chairs the Investment Management group of Loyens & Loeff and leads the fund finance practice of Loyens & Loeff in Luxembourg. He represents a variety of financial institutions, investment funds and corporations across a range of structured finance and lending transactions, with particular emphasis on fund finance, securitisation and real estate finance. Vassiliyan has extensive experience in the financing of Luxembourg alternative or regulated investment fund borrowers (including by way of capital call subscription credit facilities and permanent leverage solutions). Vassiliyan is a member of the EMEA Advisory Council of the Fund Finance Association.

FFA LEADERSHIP

Board Members

Jeff Johnston*Chairman*

Fund Finance Association

Mike Mascia*Secretary*

Fund Finance Association

Nick Mitra*First Vice Chairman*Managing Director, Credit &
Structured Finance
Societe Generale**Jeff Maier***Vice Chairman*Managing Director
First Republic Bank**Tina Meigh***Vice Chairman*Partner and Head of Fund
Finance Practice
Maples Group**Danielle Roman***Vice Chairman*Partner
Mourant**Emma Russell***Vice Chairman*Partner
Haynes Boone**Mary Touchstone***Vice Chairman*Head of Fund Finance Practice
Simpson Thacher & Bartlett LLP**Terry Hatton***Treasurer*Managing Director and
Group Head,
Fund Finance Group
MUFG Union Bank, N.A.

EMEA Executive Committee

Emma Russell

Haynes Boone

Sarah Francis

Maples Group

Billal Malik

Citibank

Robin Smith

Carey Olsen

Kathryn CecilFried, Frank, Harris, Shriver & Jacobson
(London) LLP**Helen Griffiths**

Investec

Stuart McIntosh

SMBC

Leon Stephenson

Reed Smith LLP

Charlie Bischoff

Travers Smith LLP

Samantha Hutchinson

Cadwalader, Wickersham & Taft LLP

Shelley Morrison

Abdrn

Raghav Wadhawan

Standard Chartered Bank

Parisa Clovis

Kirkland & Ellis International LLP

Joe Mahon

Coller Capital

Aimee Sharman

Mayer Brown International LLP

Jill Wilson

Lloyds Bank

EMEA Advisory Council

Haakon Blakstad

Validus Risk Mangement

Lee Doyle

Ashurst

Richard Fletcher

Macfarlanes

Guillaume Hartog

BNP Paribas

Ian Taylor

ING

Jen Yee Chan

Simmons & Simmons

Spencer Goss

RBS International

Amira Hajili

Natixis

Marcus Carrington Palmer

RBC

Vassiliyan Zanev

Loyens & Loeff

CONFERENCE FLOORPLAN

GROUND LEVEL

Registration

Churchill

- Track B

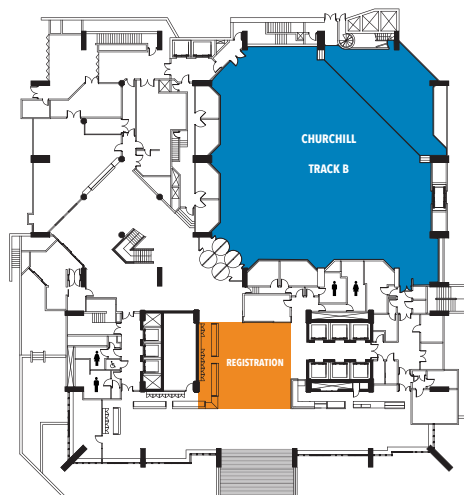

FIRST FLOOR

Pickwick

- Working Space & Lunch

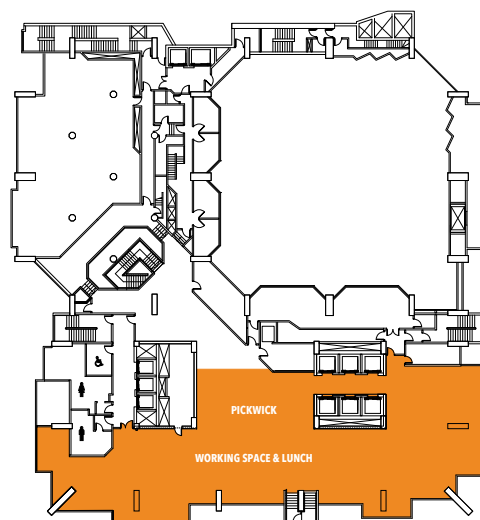

THIRD FLOOR

Fleming & Whittle

- General Session / Track A

Britten

- Exhibits & Lunch

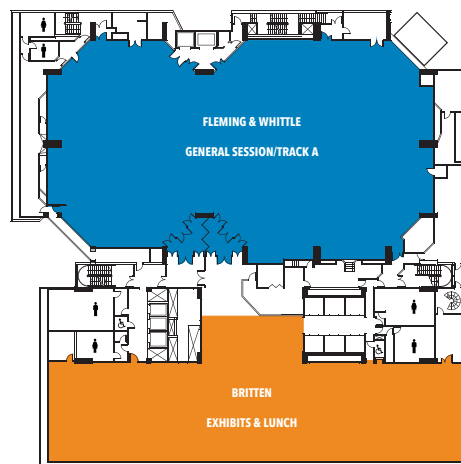

7TH ANNUAL EUROPEAN FUND FINANCE SYMPOSIUM



The Fund Finance Association (FFA) is a non-profit industry association in the fund finance market, co-located in New York, New York and Charlotte, North Carolina.

Our core mission is to;

- Educate members, legislators, regulators, and other constituencies about the fund finance market and related capital markets through conferences and other events.
- Build the broadest consensus among members on policy, legal, regulatory and other matters affecting or potentially affecting the fund finance market and related capital markets.
- Advocate on behalf of the fund finance industry with respect to policy, legal, regulatory and other matters affecting or potentially affecting the fund finance market and related capital markets.